

High Pressure
French Standard

Parkrimp No-Skive Fittings
73 Series

FG Male French Gas Series
Rigid – Straight (24° Cone)

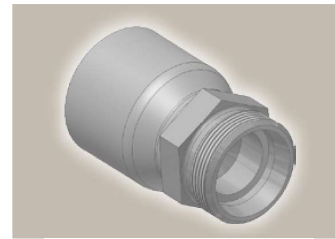
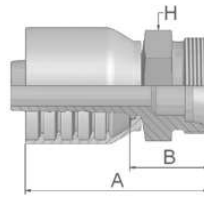

Part Number	Hose I.D.				Thread metric	Tube O.D. mm	A mm	B mm	H mm
	DN	Inch	Size	mm					
1FG73-27-12	19	3/4	-12	19.1	M36x1.5	26.75	82	33	36
1FG73-33-16	25	1	-16	25.4	M45x1.5	33.50	91	39	46

Approved **fitting series** for hose types:

73 | 731 | 731TC | SX35 | SX42



Dc-16

Catalogue 4400/UK