

D2 Male Metric 24° – Rigid Heavy Series – Straight

ISO 12151-2-S-S – CES

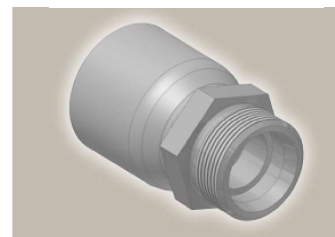
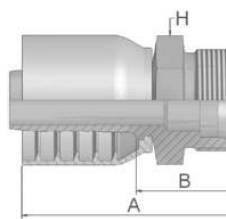

Part Number	Hose I.D.				Thread metric	Tube	A mm	B mm	H mm
	DN	Inch	Size	mm		O.D. mm			
1D243-12-6	10	3/8	-6	9,5	M20x1,5	12	55	26	22
1D243-14-6	10	3/8	-6	9,5	M22x1,5	14	55	25	22
1D243-16-8	12	1/2	-8	12,7	M24x1,5	16	62	28	24
1D243-20-10	16	5/8	-10	15,9	M30x2	20	72	33	30
1D243-20-12	19	3/4	-12	19,1	M30x2	20	72	33	30
1D243-25-12	19	3/4	-12	19,1	M36x2	25	74	35	36
1D243-30-16	25	1	-16	25,4	M42x2	30	85	40	46

Approved **fitting series** for hose types, depending on size: Also available in stainless steel. Details can be found in CAT 4400.1/UK

304 387 387ST 387TC 421WC 426 487 487ST 487TC 722 722CLF 722LT 722TC 722ST ...
787 787TC 787ST 797 797TC 797ST 881

