

CA **Female Metric 24°
Light Series with O-Ring
Swivel – Straight**
ISO 12151-2-SWS-L – DKOL

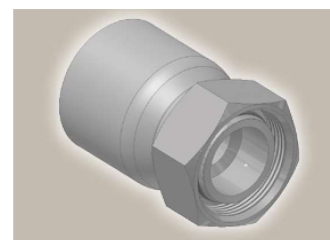
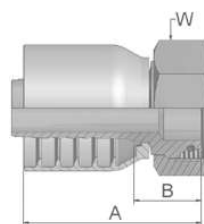

Part Number	Hose I.D.				Thread metric	Tube O.D. mm	A mm	B mm	W mm
	DN	Inch	Size	mm					
1CA70-10-6	10	3/8	-6	9,5	M16x1,5	10	53	24	19
1CA70-12-6	10	3/8	-6	9,5	M18x1,5	12	53	24	22
1CA70-15-8	12	1/2	-8	12,7	M22x1,5	15	62	27	27
1CA70-18-8	12	1/2	-8	12,7	M26x1,5	18	57	22	32
1CA70-15-10	16	5/8	-10	15,9	M22x1,5	15	66	27	27
1CA70-18-10	16	5/8	-10	15,9	M26x1,5	18	62	25	32
1CA70-22-10	16	5/8	-10	15,9	M30x2	22	64	24	36
1CA70-18-12	19	3/4	-12	19,1	M26x1,5	18	65	26	32
1CA70-22-12	19	3/4	-12	19,1	M30x2	22	63	24	36
1CA70-28-12	19	3/4	-12	19,1	M36x2	28	66	26	41
1CA70-28-16	25	1	-16	25,4	M36x2	28	78	33	41
1CA70-35-16	25	1	-16	25,4	M45x2	35	76	31	50

Fittings with standard O-ring seals can be used for temperatures from -40 °C up to +105 °C.
O-rings see section Eb. Special O-rings are available on request.

70 Series

Approved **fitting series** for hose types, depending on size:

70	371LT	372	372RH	372TC	701	701 TC	F42-8	SX35
----	-------	-----	-------	-------	-----	--------	-------	------

