



Tube clamps

Tube clamps series C (Heavy series) – Components

DIN 3015, part 2

Order code for clamp halves:

Polypropylene – **RCP**
 Inside smooth – **RCPG 1)**
 Polyamide 6 – **RCN¹⁾**
 Rubber – **RCVR**
 Aluminium – **RCA**

(Please exchange as required standard abbreviation
 RCP in column for “clamp halves”)

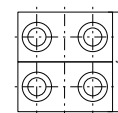
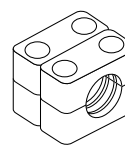
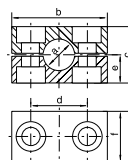
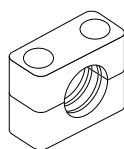

RCPD
 (= 2XRCP...)

clamp size	Tube O.D. mm	Tube NB	Tube O.D.	1 part 2 clamp halves						1 part 4 clamp halves																
				RCP... Order code	dimensions: b c d e f					RCPD... Order code	dimensions: b c d e f															
1	6.0	G 1/8	5/16	RCP106X	55	32	33	16	30	RCPD106	55	32	33	16	60											
	8.0			RCP108X						RCPD108																
	10.0			RCP110X						RCPD110																
	12.0	RCP112X	RCPD112																							
	12.7	RCP112.7X	RCPD112.7																							
	13.5	RCP113.5X	RCPD113.5																							
	14.0	RCP114X	RCPD114																							
	15.0	RCP115X	RCPD115																							
	16.0	RCP116X	RCPD116																							
	17.2	RCP117.2X	RCPD117.2																							
18.0	RCP118X	RCPD118																								
2	19.0	G 1/2	3/4	RCP219X	70	48	45	24	30	RCPD219	70	48	45	24	60											
	20.0			RCP220X						RCPD220																
	21.3			RCP221.3X						RCPD221.3																
	22.0	RCP222X	RCPD222																							
	23.0	RCP223X	RCPD223																							
	25.0	RCP225X	RCPD225																							
	26.9	RCP226.9X	RCPD226.9																							
	28.0	RCP228X	RCPD228																							
	30.0	RCP230X	RCPD230																							
	3	30.0	G 1	1 1/4						RCP330X						85	60	60	30	30	RCPD330	85	60	60	30	60
32.0		RCP332X			RCPD332																					
33.7		RCP333.7X			RCPD333.7																					
35.0		RCP335X	RCPD335																							
38.0		RCP338X	RCPD338																							
39.0		RCP339X	RCPD339																							
40.0		RCP340X	RCPD340																							
42.0		RCP342X	RCPD342																							
4		38.0	G 1 1/4	1 1/2	RCP438X	115	90	90	45	45	RCPD438	115	90	90	45						90					
		39.0			RCP439X						RCPD439															
	40.0	RCP440X			RCPD440																					
	42.0	RCP442X	RCPD442																							
	45.0	RCP445X	RCPD445																							
	46.0	RCP446X	RCPD446																							
	48.3	RCP448.3X	RCPD448.3																							
	50.0	RCP450X	RCPD450																							
	51.0	RCP451X	RCPD451																							
	52.0	RCP452X	RCPD452																							
	55.0	RCP455X	RCPD455																							
	56.0	RCP456X	RCPD456																							
	57.0	RCP457X	RCPD457																							
	60.3	RCP460.3X	RCPD460.3																							
	63.0	RCP463X	RCPD463																							
	65.0	RCP465X	RCPD465																							
66.0	RCP466X	RCPD466																								

Continuation see next page ...

Tube clamps series C (Heavy series) – Components (Continued)

DIN 3015, part 2

Order code for clamp halves:

 Polypropylene – **RCP**
 Inside smooth – **RCPG**¹⁾
 Polyamide 6 – **RCN**¹⁾
 Rubber – **RCVR**
 Aluminium – **RCA**

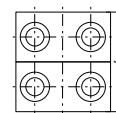
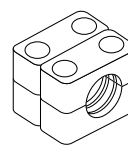
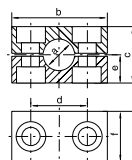
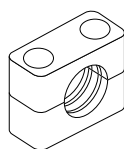
 (Please exchange as required standard abbreviation
 RCP in column for “clamp halves”)

RCPD
 (= 2XRCP...)

clamp size	Tube O.D. mm	Tube NB	Tube O.D.	1 part 2 clamp halves						1 part 4 clamp halves																
				RCP... Order code	dimensions:					RCPD... Order code	dimensions:															
				b	c	d	e	f	b	c	d	e	f													
5	70.0	G 2 1/2	3	RCP470X	152	120	122	60	60	RCPD470	152	120	122	60	120											
	70.0			RCP570X						RCPD570																
	73.0			RCP573X						RCPD573																
	75.0			RCP575X						RCPD575																
	76.1			RCP576.1X						RCPD576.1																
	80.0	RCP580X	RCPD580																							
	82.5	RCP582.5X	RCPD582.5																							
	88.9	RCP588.9X	RCPD588.9																							
	90.0	RCP590X	RCPD590																							
	6	90.0	G 3 1/2	4						RCP690X						205	170	168	85	80	RCPD690	205	170	168	85	160
97.0		RCP697X			RCPD697																					
100.0		RCP6100X			RCPD6100																					
101.6		RCP6101.6X			RCPD6101.6																					
108.0		RCP6108X			RCPD6108																					
114.3		RCP6114.3X	RCPD6114.3																							
127.0		RCP6127X	RCPD6127																							
7		127.0	G 5	5	RCP7127X	250	200	205	100	90	RCPD7127	250	200	205	100						180					
		133.0			RCP7133X						RCPD7133															
		140.0			RCP7140X						RCPD7140															
	150.0	RCP7150X			RCPD7150																					
	152.4	RCP7152.4X			RCPD7152.4																					
	159.0	RCP7159X	RCPD7159																							
	165.1	RCP7165.1X	RCPD7165.1																							
	168.3	RCP7168.3X	RCPD7168.3																							
	8	168.3	G 6	6	RCP8168.3X						320					270	265	135	120	RCPD8168.3		320	270	265	135	240
		177.8			RCP8177.8X															RCPD8177.8						
193.7		RCP8193.7X			RCPD8193.7																					
203.0		RCP8203X			RCPD8203																					
219.1		RCP8219.1X			RCPD8219.1																					
220.0		RCP8220X	RCPD8220																							
9		219.1	G 8	8	RCP9219.1X	466	410	395	205	160		RCPD9219.1	466	410	395					205	320					
		244.5			RCP9244.5X							RCPD9244.5														
		250.0			RCP9250X							RCPD9250														
		273.0			RCP9273X							RCPD9273														
	323.9	RCP9323.9X			RCPD9323.9																					
10	355.6	G 10	10	RCP10355.6X	630	530	530	265	180	RCPD10355.6	630	530	530	265	360											
	406.4			RCP10406.4X						RCPD10406.4																

Metal parts also available in stainless steel.

¹⁾ Only sizes 1–4

Tube clamps



Tube clamps series C (Heavy series) – Components

DIN 3015, part 2

clamp size	weld plate					double weld plate					weld/screw plate					mounting rail					
	AP C... Order code	dimensions:					APD C... Order code	dimensions:					APL C... Order code	dimensions:					TS C... Order code	dim.:	
		d	f	g	i	m		d	f	g	i	m		g	f	i	k	n		b	h
1	APC1X	33	30	73	8	M10	APDC1X	33	60	73	8	M10	APLC1X	113	30	8	85	11	TSC1X (1 Meter)	40	22
2	APC2X	45	30	85	8	M10	APDC2X	45	60	85	8	M10	APLC2X	125	30	8	97	11			
3	APC3X	60	30	100	8	M10	APDC3X	60	60	100	8	M10	APLC3X	140	30	8	112	11	TSC2X (2 Meter)		
4	APC4X	90	45	140	10	M12	APDC4X	90	90	140	10	M12	APLC4X	190	45	10	160	14			
5	APC5X	122	60	180	10	M16	APDC5X	122	120	180	10	M16	APLC5X	240	60	10	205	18			
6	APC6X	168	80	225	15	M20	APDC6X	168	160	225	15	M20	APLC6X	310	80	15	270	22			
7	APC7X	205	90	270	15	M24	APDC7X	205	180	270	15	M24	APLC7X	370	90	15	320	26			
8	APC8X	265	120	340	25	M30	APDC8X	265	240	340	25	M30	APLC8X	450	120	25	390	33			
9	APC9X	395	160	520	30	M30	APDC9X	395	324	520	30	M30									
10	APC10X	530	180	680	30	M30	APDC10X	530	364	680	30	M30									

Metal parts also available in stainless steel.

Complete programme range please refer to page T29.



Tube clamps

Tube clamps series C (Heavy series) – Components

DIN 3015, part 2

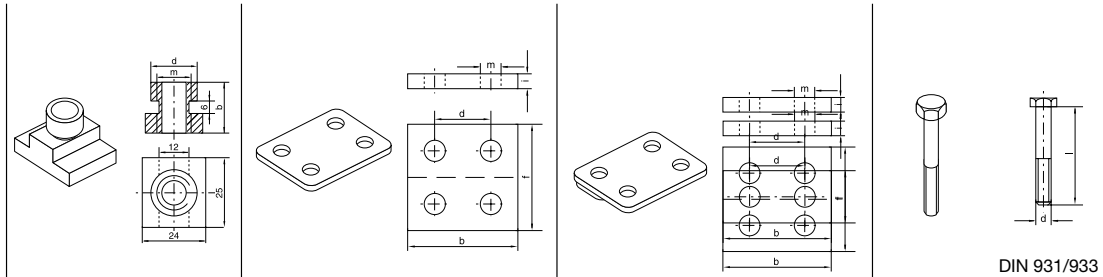

clamp size	rail nut			cover plate					double cover plate					hexagon head				
	TM C... Order code	dimensions:			DP C... Order code	dimensions:					DPD C... Order code	dimensions:					SS C... Order code	dimensions:
		b	d	m		b	d	f	i	m		b	d	f	i	m		d x L
1	TMC1X	20	17.8	M10	DPC1X	55	33	30	8	11	DPDC1X	55	33	60	8	11	SSC1X	M 10×40
2					DPC2X	70	45	30	8	11	DPDC2X	70	45	60	8	11	SSC2X	M 10×60
3					DPC3X	85	60	30	8	11	DPDC3X	85	60	60	8	11	SSC3X	M 10×70
4	TMC4X	23	19.8	M12	DPC4X	115	90	45	10	14	DPDC4X	115	90	90	10	14	SSC4X	M 12×100
5					DPC5X	152	122	60	10	18	DPDC5X	152	122	120	10	18	SSC5X	M 16×130
6					DPC6X	205	168	80	15	22	DPDC6X	205	168	160	15	22	SSC6X	M 20×190
7					DPC7X	250	205	90	15	26	DPDC7X	250	205	180	15	26	SSC7X	M 24×220
8					DPC8X	320	265	120	25	33	DPDC8X	320	265	240	25	33	SSC8X	M 30×300
9					DPC9X	466	395	160	30	35	DPDC9X	466	395	324	30	35	SSC9X	M 30×450
10					DPC10X	630	530	364	30	35	DPDC10X	630	530	364	30	35	SSC10X	M 30×560

Metal parts also available in stainless steel.



Tube clamps



Tube clamps series C (Heavy series) – Components

DIN 3015, part 2

clamp size	socket head		stacking				locking plate ¹⁾					locking washer ²⁾				
	IS C... Order code	dimensions: d x L	AS C... Order code	dimensions:				SP C... Order code	dimensions:					US C... Order code	dimensions:	
				a	b	m	SW		a	b	c	d	e		a	b
1	ISC1X	M 10×45	ASC1X	25	51	M10	15	SPC1X	55	30	8	14	15.5	USC1X	13	22
2	ISC2X	M 10×60	ASC2X	40	66	M10	15	SPC2X	70	30	8	26	15.5			
3	ISC3X	M 10×70	ASC3X	50	76	M10	15	SPC3X	85	30	8	41	15.5			
4	ISC4X	M 12×100	ASC4X	85	112	M12	17	SPC4X	115	45	10	69	17.5	USC4X	15	28
5	ISC5X	M 16×130	ASC5X	110	146	M16	21	SPC5X	152	60	10	97	21.5	USC5X	18	32
6	ISC6X	M 20×190	ASC6X	155	206	M20	27	SPC6X	205	80	15	137	27.5	USC6X	21	36
7	ISC7X	M 24×220	ASC7X	185	245	M24	30	SPC7X	250	90	15	169	30.5	USC7X	25	42
8	ISC8X	M 30×300	ASC8X	250	330	M30	36	SPC8X	320	120	25	219	36.5	USC8X	32	52

¹⁾ The use of stacking screws necessitates the use of locking plates in the construction assembly!

²⁾ When assembling solid rubber clamps, covering plates, hexagon screws and locking washers must be used.
Metal parts also available in stainless steel.



Tube clamps

Tube clamps series C – Complete range

Polypropylene – **RCP**
 Inside smooth – **RCPG¹**
 Polyamide 6 – **RCN**
 Rubber – **RCVR***
 Aluminium – **RCA**

(As required please exchange standard abbreviation
 RCP in column for "Order code")

2 clamp halves, weld plate,
 cover plate, hex. head bolt

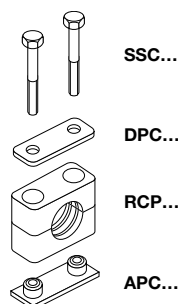

2 clamp halves, weld plate,
 cover plate, socket head bolt

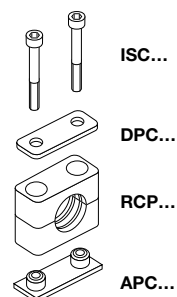

clamp size	Tube O.D. mm	Tube NB	Tube O.D.	Order code	Order code
1	6.0	G 1/8	5/16	RCP1-106	RCP2-106
	8.0			RCP1-108	RCP2-108
	10.0			RCP1-110	RCP2-110
	12.0			RCP1-112	RCP2-112
	12.7	G 1/4	1/2	RCP1-112.7	RCP2-112.7
	13.5			RCP1-113.5	RCP2-113.5
	14.0			RCP1-114	RCP2-114
	15.0			RCP1-115	RCP2-115
	16.0	G 3/8	5/8	RCP1-116	RCP2-116
	17.2			RCP1-117.2	RCP2-117.2
18.0	RCP1-118			RCP2-118	
2	19.0	G 1/2	3/4	RCP1-219	RCP2-219
	20.0			RCP1-220	RCP2-220
	21.3			RCP1-221.3	RCP2-221.3
	22.0			RCP1-222	RCP2-222
	23.0	G 3/4	1	RCP1-223	RCP2-223
	25.0			RCP1-225	RCP2-225
	26.9			RCP1-226.9	RCP2-226.9
	28.0			RCP1-228	RCP2-228
	30.0			RCP1-230	RCP2-230
3	30.0	G 1	1 1/4	RCP1-330	RCP2-330
	32.0			RCP1-332	RCP2-332
	33.7			RCP1-333.7	RCP2-333.7
	35.0			RCP1-335	RCP2-335
	38.0	G 1 1/4	1 1/2	RCP1-338	RCP2-338
	40.0			RCP1-340	RCP2-340
	42.0			RCP1-342	RCP2-342
4	38.0	G 1 1/4	1 1/2	RCP1-438	RCP2-438
	40.0			RCP1-440	RCP2-440
	42.0			RCP1-442	RCP2-442
	45.0			RCP1-445	RCP2-445
	48.3	G 1 1/2	2	RCP1-448.3	RCP2-448.3
	50.0			RCP1-450	RCP2-450
	51.0			RCP1-451	RCP2-451
	52.0			RCP1-452	RCP2-452
	55.0	G 2	2 1/4	RCP1-455	RCP2-455
	57.0			RCP1-457	RCP2-457
	60.3			RCP1-460.3	RCP2-460.3
	63.0			RCP1-463	RCP2-463
	65.0			RCP1-465	RCP2-465
	70.0			RCP1-470	RCP2-470

Continuation see next page ...





Tube clamps

Tube clamps series C – Complete range (Continued)

Polypropylene – **RCP**
 Inside smooth – **RCPG**¹⁾
 Polyamide 6 – **RCN**
 Rubber – **RCVR***
 Aluminium – **RCA**

(As required please exchange standard abbreviation
 RCP in column for "Order code")

2 clamp halves, weld plate,
 cover plate, hex. head bolt

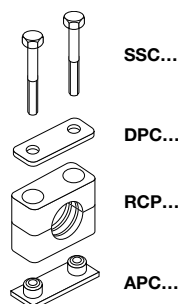

2 clamp halves, weld plate,
 cover plate, socket head bolt

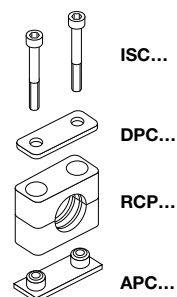

clamp size	Tube O.D. mm	Tube NB	Tube O.D.	Order code	Order code	
5	70.0	G 2 1/2	3	RCP1-570	RCP2-570	
	73.0			RCP1-573	RCP2-573	
	75.0			RCP1-575	RCP2-575	
	76.1			RCP1-576.1	RCP2-576.1	
	80.0	G 3	3 1/4	RCP1-580	RCP2-580	
	82.5			RCP1-582.5	RCP2-582.5	
	88.9			RCP1-588.9	RCP2-588.9	
90.0			RCP1-590	RCP2-590		
6	90.0	G 3 1/2	4	RCP1-690	RCP2-690	
	97.0			RCP1-697	RCP2-697	
	100.0			RCP1-6100	RCP2-6100	
	101.6			RCP1-6101.6	RCP2-6101.6	
	108.0	G 4	4 1/4	RCP1-6108	RCP2-6108	
	114.3			RCP1-6114.3	RCP2-6114.3	
127.0		5	RCP1-6127	RCP2-6127		
7	127.0	G 5	5	RCP1-7127	RCP2-7127	
	133.0			RCP1-7133	RCP2-7133	
	140.0			RCP1-7140	RCP2-7140	
	150.0	G 5 1/2	6	RCP1-7150	RCP2-7150	
	152.4			RCP1-7152.4	RCP2-7152.4	
	159.0	G 6	6 1/4	RCP1-7159	RCP2-7159	
	165.1			RCP1-7165.1	RCP2-7165.1	
168.3	RCP1-7168.3			RCP2-7168.3		
8	168.3	G 8	6 5/8	RCP1-8168.3	RCP2-8168.3	
	177.8		7	RCP1-8177.8	RCP2-8177.8	
	193.7		7 5/8	RCP1-8193.7	RCP2-8193.7	
	203.0		8 5/8		RCP1-8203	RCP2-8203
	219.1				RCP1-8219.1	RCP2-8219.1
	220.0				RCP1-8220	RCP2-8220

Delivery in unassembled individual components.

¹⁾ Only sizes 1-4

* Only with cover plate, hexagon screws and locking washers (only sizes 1-4).



Tube clamps

Tube clamps series C – Complete range

Polypropylene – **RCP**
 Inside smooth – **RCPG¹**
 Polyamide 6 – **RCN**
 Rubber – **RCVR***
 Aluminium – **RCA**

(As required please exchange standard abbreviation
 RCP in column for "Order code")

2 clamp halves,
 rail nuts, cover plate,
 hex. head bolts

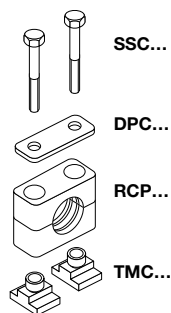

2 clamp halves,
 rail nuts, cover plate,
 socket head bolts

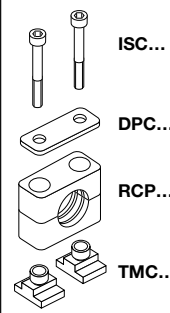

2 clamp halves, lock-
 ing plate, stacking
 bolts

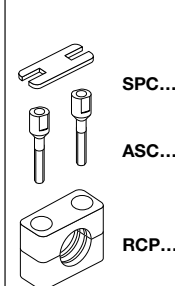

clamp size	Tube O.D. mm	Tube NB	Tube O.D.	Order code	Order code	Order code
1	6.0	G 1/8	5/16	RCP3-106	RCP4-106	RCP5-106
	8.0			RCP3-108	RCP4-108	RCP5-108
	10.0			RCP3-110	RCP4-110	RCP5-110
	12.0			RCP3-112	RCP4-112	RCP5-112
	12.7	G 1/4	1/2	RCP3-112.7	RCP4-112.7	RCP5-112.7
	13.5			RCP3-113.5	RCP4-113.5	RCP5-113.5
	14.0			RCP3-114	RCP4-114	RCP5-114
	15.0			RCP3-115	RCP4-115	RCP5-115
	16.0	G 3/8	5/8	RCP3-116	RCP4-116	RCP5-116
	17.2			RCP3-117.2	RCP4-117.2	RCP5-117.2
18.0	RCP3-118			RCP4-118	RCP5-118	
2	19.0			G 1/2	3/4	RCP3-219
	20.0	RCP3-220	RCP4-220			RCP5-220
	21.3	RCP3-221.3	RCP4-221.3			RCP5-221.3
	22.0	RCP3-222	RCP4-222			RCP5-222
	23.0	G 3/4	1	RCP3-223	RCP4-223	RCP5-223
	25.0			RCP3-225	RCP4-225	RCP5-225
	26.9			RCP3-226.9	RCP4-226.9	RCP5-226.9
	28.0			RCP3-228	RCP4-228	RCP5-228
30.0	RCP3-230	RCP4-230	RCP5-230			
3	30.0	G 1	1 1/4	RCP3-330	RCP4-330	RCP5-330
	32.0			RCP3-332	RCP4-332	RCP5-332
	33.7			RCP3-333.7	RCP4-333.7	RCP5-333.7
	35.0			RCP3-335	RCP4-335	RCP5-335
	38.0	G 1 1/4	1 1/2	RCP3-338	RCP4-338	RCP5-338
	40.0			RCP3-340	RCP4-340	RCP5-340
42.0	RCP3-342	RCP4-342	RCP5-342			
4	38.0	G 1 1/4	1 1/2	RCP3-438	RCP4-438	RCP5-438
	40.0			RCP3-440	RCP4-440	RCP5-440
	42.0			RCP3-442	RCP4-442	RCP5-442
	45.0			RCP3-445	RCP4-445	RCP5-445
	48.3	G 1 1/2	2	RCP3-448.3	RCP4-448.3	RCP5-448.3
	50.0			RCP3-450	RCP4-450	RCP5-450
	51.0	G 2	2 1/4	RCP3-451	RCP4-451	RCP5-451
	52.0			RCP3-452	RCP4-452	RCP5-452
	55.0			RCP3-455	RCP4-455	RCP5-455
	57.0			RCP3-457	RCP4-457	RCP5-457
	60.3			RCP3-460.3	RCP4-460.3	RCP5-460.3
	63.0			RCP3-463	RCP4-463	RCP5-463
	65.0			RCP3-465	RCP4-465	RCP5-465
	70.0			RCP3-470	RCP4-470	RCP5-470

Continuation see next page ...



Tube clamps



Tube clamps series C – Complete range (Continued)

Polypropylene – **RCP**
 Inside smooth – **RCPG¹⁾**
 Polyamide 6 – **RCN**
 Rubber – **RCVR***
 Aluminium – **RCA**

(As required please exchange standard abbreviation
 RCP in column for "Order code")

2 clamp halves, locking
 plate, stacking bolts

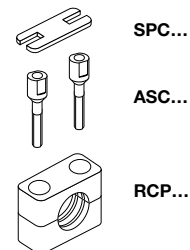

clamp size	Tube O.D. mm	Tube NB	Tube O.D.	Order code
5	70.0	G 2 1/2	3	RCP5-570
	73.0			RCP5-573
	75.0			RCP5-575
	76.1			RCP5-576.1
	80.0	G 3	3 1/4 3 1/2	RCP5-580
	82.5			RCP5-582.5
	88.9			RCP5-588.9
90.0			RCP5-590	
6	90.0	G 3 1/2	4	RCP5-690
	97.0			RCP5-697
	100.0			RCP5-6100
	101.6	G 4	4 1/4 4 1/2 5	RCP5-6101.6
	108.0			RCP5-6108
	114.3			RCP5-6114.3
127.0			RCP5-6127	
7	127.0	G 5	5 5 1/4 5 1/2	RCP5-7127
	133.0			RCP5-7133
	140.0			RCP5-7140
	150.0	G 5 1/2	6 6 1/4 6 1/2 6 5/8	RCP5-7150
	152.4			RCP5-7152.4
	159.0			RCP5-7159
	165.1			RCP5-7165.1
168.3	G 6		RCP5-7168.3	
8	168.3	G 8	6 5/8	RCP5-8168.3
	177.8		7	RCP5-8177.8
	193.7		75/8	RCP5-8193.7
	203.0			RCP5-8203
	219.1		85/8	RCP5-8219.1
	220.0			

Delivery in unassembled individual components.

¹⁾ Only sizes 1–4

* Only with cover plate, hexagon screws and locking washers (only sizes 1–4).



Tube clamps

Tube clamps series C – Complete range

Polypropylene – **RCPD**
 Inside smooth – **RCPDG¹**
 Polyamide 6 – **RCND**
 Rubber – **RCVDR***
 Aluminium – **RCAD**

(As required please exchange standard abbreviation
 RCP in column for "Order code")

4 clamp halves, double weld plate,
 double cover plate, hex. head
 bolts

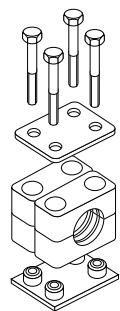

SSC...

DPDC...

RCPD...
 (=2XRCP...)

APDC...

4 clamp halves, double weld
 plate, double cover plate, socket
 head bolts

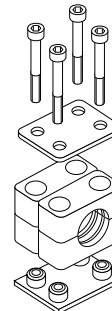

ISC...

DPDC...

RCPD...
 (=2XRCP...)

APDC...

clamp size	Tube O.D. mm	Tube NB	Tube O.D.	Order code	Order code
1	6.0	G 1/8	5/16	RCPD1-106	RCPD2-106
	8.0			RCPD1-108	RCPD2-108
	10.0			RCPD1-110	RCPD2-110
	12.0			RCPD1-112	RCPD2-112
	12.7	G 1/4	1/2	RCPD1-112.7	RCPD2-112.7
	13.5			RCPD1-113.5	RCPD2-113.5
	14.0			RCPD1-114	RCPD2-114
	15.0			RCPD1-115	RCPD2-115
	16.0	G 3/8	5/8	RCPD1-116	RCPD2-116
	17.2			RCPD1-117.2	RCPD2-117.2
18.0	RCPD1-118			RCPD2-118	
2	19.0			G 1/2	3/4
	20.0	RCPD1-220	RCPD2-220		
	21.3	RCPD1-221.3	RCPD2-221.3		
	22.0	RCPD1-222	RCPD2-222		
	23.0	G 3/4	1	RCPD1-223	RCPD2-223
	25.0			RCPD1-225	RCPD2-225
	26.9			RCPD1-226.9	RCPD2-226.9
	28.0			RCPD1-228	RCPD2-228
	30.0			RCPD1-230	RCPD2-230
	3			30.0	G 1
32.0		RCPD1-332	RCPD2-332		
33.7		RCPD1-333.7	RCPD2-333.7		
35.0		RCPD1-335	RCPD2-335		
38.0		G 1 1/4	1 1/2	RCPD1-338	RCPD2-338
40.0				RCPD1-340	RCPD2-340
42.0				RCPD1-342	RCPD2-342
4				38.0	G 1 1/4
	40.0	RCPD1-440	RCPD2-440		
	42.0	RCPD1-442	RCPD2-442		
	45.0	RCPD1-445	RCPD2-445		
	48.3	G 1 1/2	2	RCPD1-448.3	RCPD2-448.3
	50.0			RCPD1-450	RCPD2-450
	51.0			RCPD1-451	RCPD2-451
	52.0			RCPD1-452	RCPD2-452
	55.0	G 2	2 1/4	RCPD1-455	RCPD2-455
	57.0			RCPD1-457	RCPD2-457
	60.3			RCPD1-460.3	RCPD2-460.3
	63.0			RCPD1-463	RCPD2-463
	65.0			RCPD1-465	RCPD2-465
	70.0			RCPD1-470	RCPD2-470

Continuation see next page ...





Tube clamps

Tube clamps series C – Complete range (Continued)

Polypropylene – **RCPD**
 Inside smooth – **RCPDG**¹⁾
 Polyamide 6 – **RCND**
 Rubber – **RCVDR***
 Aluminium – **RCAD**

(As required please exchange standard abbreviation RCP in column for "Order code")

4 clamp halves, double weld plate, double cover plate, hex. head bolts

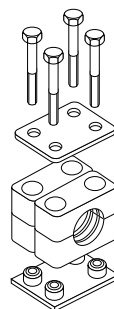

SSC...

DPDC...

RCPD...
(=2XRCP...)

APDC...

4 clamp halves, double weld plate, double cover plate, socket head bolts

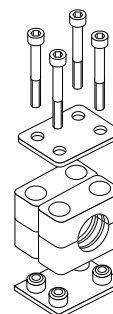

ISC...

DPDC...

RCPD...
(=2XRCP...)

APDC...

clamp size	Tube O.D. mm	Tube NB	Tube O.D.	Order code	Order code
5	70.0	G 2 1/2	3	RCPD1-570	RCPD2-570
	73.0			RCPD1-573	RCPD2-573
	75.0			RCPD1-575	RCPD2-575
	76.1			RCPD1-576.1	RCPD2-576.1
	80.0	G 3	3 1/4	RCPD1-580	RCPD2-580
	82.5			RCPD1-582.5	RCPD2-582.5
88.9	RCPD1-588.9			RCPD2-588.9	
90.0			RCPD1-590	RCPD2-590	
6	90.0	G 3 1/2	4	RCPD1-690	RCPD2-690
	97.0			RCPD1-697	RCPD2-697
	100.0			RCPD1-6100	RCPD2-6100
	101.6			RCPD1-6101.6	RCPD2-6101.6
	108.0	G 4	4 1/4	RCPD1-6108	RCPD2-6108
	114.3			RCPD1-6114.3	RCPD2-6114.3
127.0	RCPD1-6127			RCPD2-6127	
7	127.0	G 5	5	RCPD1-7127	RCPD2-7127
	133.0			RCPD1-7133	RCPD2-7133
	140.0			RCPD1-7140	RCPD2-7140
	150.0	G 5 1/2	6	RCPD1-7150	RCPD2-7150
	152.4			RCPD1-7152.4	RCPD2-7152.4
	159.0			RCPD1-7159	RCPD2-7159
	165.1	G 6	6 1/2	RCPD1-7165.1	RCPD2-7165.1
	168.3			RCPD1-7168.3	RCPD2-7168.3
8	168.3	G 8	6 5/8	RCPD1-8168.3	RCPD2-8168.3
	177.8		7	RCPD1-8177.8	RCPD2-8177.8
	193.7		7 5/8	RCPD1-8193.7	RCPD2-8193.7
	203.0		8 5/8	RCPD1-8203	RCPD2-8203
	219.1			RCPD1-8219.1	RCPD2-8219.1
	220.0			RCPD1-8220	RCPD2-8220

Delivery in unassembled individual components.

¹⁾ Only sizes 1-4

* Only with cover plate, hexagon screws and locking washers (only sizes 1-4).