

TRMTX Tube end reducer

Triple-Lok® 37° Flare end / Triple-Lok® 37° Flare female swivel* end

SAE 070123 MS51534

*Form A Fixed Female Style

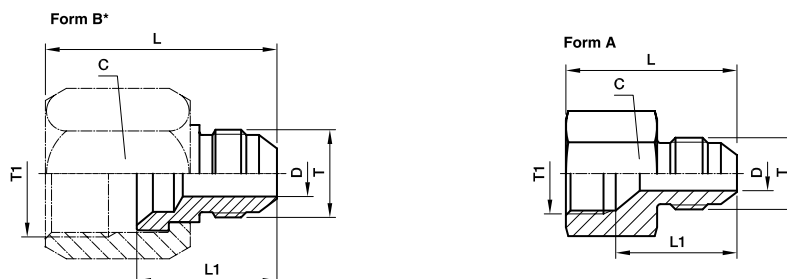

* For Form B, a BTX- or BMTX-nut is required (to be ordered separately)

Tube Metric T1 O.D.	Tube Metric T O.D.	Tube in. T1 O.D.	Tube in. T O.D.	Thread UN/UNF-2B T1	Thread UN/UNF-2A T	Typ	C mm	D mm	L mm	L1 mm	Weight (steel) g/1 piece	Triple-Lok®		PN (bar)		
												Steel	Stainless Steel	Brass	S	SS
8	6	5/16	1/8	7/16-20	5/16-24	B	14.3	1.6	29	19	16	4-2 TRTX-S	4-2TRMTXS	6-4 TRTX-B	500	350
10	6	3/8	1/4	9/16-18	7/16-20	B	17	4.4	29	20	21	5-4TRMTXS	5-4TRMTXS		420	350
10	8	3/8	5/16	9/16-18	1/2-20	A	19	6	30	21	29	6-4TRTXS	6-4TRMTXS		420	350
12	6	1/2	1/4	3/4-16	7/16-20	B	22	4.4	38	25.5	38	6-5TRMTXS	6-5TRMTXS		420	350
12	8	1/2	5/16	3/4-16	1/2-20	B	22	6	38	25.5	35	8-4TRTXS	8-4TRMTXS	8-4 TRTX-B	420	350
12	10	1/2	3/8	3/4-16	9/16-18	B	22	7.5	38	25.5	32	8-5TRTXS	8-5TRMTXS	8-6 TRTX-B	420	350
14, 15, 16	6	5/8	1/4	7/8-14	7/16-20	B	27	4.4	41	26	83	8-6TRTXS	8-6TRMTXS	10-6 TRTX-B	350	350
14, 15, 16	8	5/8	5/16	7/8-14	1/2-20	B	27	6	41	26	80	10-4 TRTX-S	10-4TRMTXS		350	350
14, 15, 16	8	5/8	5/16	7/8-14	1/2-20	B	27	6	41	26	80	10-5TRTXS	10-5TRMTXS		350	350
14, 15, 16	10	5/8	3/8	7/8-14	9/16-18	B	27	7.5	41	26	78	10-6 TRTX-S	10-6TRMTXS		350	350
14, 15, 16	12	5/8	1/2	7/8-14	3/4-16	A	27	9.9	36.5	24.5	73	10-8TRMTXS	10-8TRMTXS	12-4 TRTX-B	350	350
18, 20	6	3/4	1/4	1 1/16-12	7/16-20	B	31.8	4.4	42.5	27.5	120	12-4 TRTX-S	12-4TRMTXS		350	350
18, 20	8	3/4	5/16	1 1/16-12	1/2-20	B	32	6	42.5	27.5	118	12-5TRTXS	12-5TRMTXS		350	350
18, 20	10	3/4	3/8	1 1/16-12	9/16-18	B	31.8	7.5	43	27.5	115	12-6 TRTX-S	12-6TRMTXS		350	350
18, 20	12	3/4	1/2	1 1/16-12	3/4-16	B	32	9.9	45	30	128	12-8TRTXS	12-8TRMTXS	12-6 TRTX-B	350	350
18, 20	14, 15, 16	3/4	5/8	1 1/16-12	7/8-14	A	32	12.3	42	29.5	119	12-8TRTXS	12-8TRMTXS	12-8 TRTX-B	350	350
22	10	7/8	3/8	1 3/16-12	9/16-18	B	35	7.5	45	29	102	12-10TRMTXS	12-10TRMTXS		350	350
22	14, 15, 16	7/8	5/8	1 3/16-12	7/8-14	B	35	12.3	50	34	120	14-6 TRTX-S	14-6TRMTXS		350	350
22	18, 20	7/8	3/4	1 3/16-12	1 1/16-12	A	35	15.5	46.5	33	166	14-10 TRTX-S	14-10TRMTXS		350	350
25	6	1	1/4	1 5/16-12	7/16-20	B	38	4.4	46.5	31	205	14-12 TRTX-S	14-12TRMTXS	16-4 TRTX-S	310	350
25	10	1	3/8	1 5/16-12	9/16-18	B	41	7.5	46.5	29.5	215	16-4 TRTX-S	16-4TRMTXS	16-6 TRTX-B	310	350
25	12	1	1/2	1 5/16-12	3/4-16	B	38	9.9	49	32	228	16-6TRTXS	16-6TRMTXS		310	350
25	14, 15, 16	1	5/8	1 5/16-12	7/8-14	B	41	12.3	52	34.5	239	16-8 TRTX-S	16-8TRMTXS		310	350
25	18, 20	1	3/4	1 5/16-12	1 1/16-12	B	41	15.5	54.5	37	252	16-10TRTXS	16-10TRMTXS		310	350
25	22	1	7/8	1 5/16-12	1 3/16-12	A	38	18.2	48.5	34	224	16-12TRTXS	16-12TRMTXS	16-14 TRTX-S	310	280
28, 30, 32	12	1 1/4	1/2	1 5/8-12	3/4-16	B	50	9.9	54	36	380	16-14 TRTX-S	16-14TRMTXS	20-8 TRTX-B	310	280
28, 30, 32	14, 15, 16	1 1/4	5/8	1 5/8-12	7/8-14	B	50	12.3	56	38	380	20-8TRTXS	20-8TRMTXS		280	280
28, 30, 32	18, 20	1 1/4	3/4	1 5/8-12	1 1/16-12	B	50	15.5	57	39	370	20-10TRTXS	20-10TRMTXS		280	280
28, 30, 32	25	1 1/4	1	1 5/8-12	1 5/16-12	B	50	21.5	59	40.5	355	20-12TRTXS	20-12TRMTXS		280	280
35, 38	20	1 1/2	3/4	1 7/8-12	1 1/16-12	B	60	15.5	63	41.5	520	20-16TRTXS	20-16TRMTXS	24-12TRTXS	210	280
35, 38	25	1 1/2	1	1 7/8-12	1 5/16-12	B	57	21.5	63	41.5	570	24-12TRTXS	24-12TRMTXS	24-16 TRTX-B	210	140
35, 38	28, 30, 32	1 1/2	1 1/4	1 7/8-12	1 5/8-12	B	57	27.4	64	43	614	24-16 TRTX-S	24-16TRMTXS		210	140
42	35, 38			2 1/4-12	1 7/8-12	B	65	33.3	72	48.5	839	24-20 TRTX-S	24-20TRMTXS		140	140
50	38	2	1 1/2	2 1/2-12	1 7/8-12	B	73	33.3	75	48.5	900	28-24TRTXS	28-24TRMTXS		140	—



Order codes shown are part of our current manufacturing programme.

Imperial and metric parts may vary in hexagon dimensions.

$$\frac{\text{PN (bar)}}{10} = \text{PN (MPa)}$$

Pressure ratings – PN shown, apply to Steel and Stainless Steel versions of the product.

For Brass parts reduce pressures by 35 %

Do not create drawings from these dimensions, they are subject to change and ISO manufacturing allowances.