

## Adapters

### H6MK4 Swivel nut union

BSPP 60° Female swivel ends (ISO 8434-6)

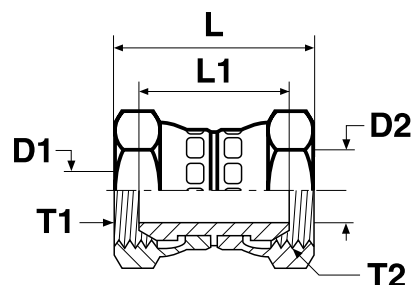

Thread BSPP T1	Thread BSPP T2	D1 mm	D2 mm	L mm	L1 mm	Weight (steel) g/1 piece	Adapter Steel	Adapter Stainless Steel	PN (bar)	
									S	SS
1/4-19	1/4-19	4.7	4.7	38	27	50	<b>4H6MK4S</b>	<b>4H6MK4SS</b>	350	350
3/8-19	1/4-19	7.9	4.7	40	28	61	<b>6-4H6MK4S</b>	<b>6-4H6MK4SS</b>	350	350
3/8-19	3/8-19	7.9	7.9	42	29	73	<b>6H6MK4S</b>	<b>6H6MK4SS</b>	350	350
1/2-14	1/4-19	11.1	4.7	43	30	85	<b>8-4H6MK4S</b>	<b>8-4H6MK4SS</b>	200	200
1/2-14	3/8-19	11.1	7.9	44	31	96	<b>8-6H6MK4S</b>	<b>8-6H6MK4SS</b>	200	200
1/2-14	1/2-14	11.1	11.1	47	33	107	<b>8H6MK4S</b>	<b>8H6MK4SS</b>	200	200
5/8-14	5/8-14	14.3	14.3	48	29	130	<b>10H6MK4S</b>	<b>10H6MK4SS</b>	200	200
3/4-14	1/2-14	16.7	11.1	49	33	152	<b>12-8H6MK4S</b>	<b>12-8H6MK4SS</b>	200	200
3/4-14	3/4-14	16.7	16.7	50	32	167	<b>12H6MK4S</b>	<b>12H6MK4SS</b>	200	200
1-11	1-11	22.2	22.2	57	35	201	<b>16H6MK4S</b>	<b>16H6MK4SS</b>	120	120
1 1/4-11	1 1/4-11	28.6	28.6	66	45	340	<b>20H6MK4S</b>	<b>20H6MK4SS</b>	105	105
1 1/2-11	1 1/2-11	33.3	33.3	70	43	583	<b>24H6MK4S</b>	<b>24H6MK4SS</b>	105	105

Order codes shown are part of our current manufacturing programme.

Imperial and metric parts may vary in hexagon dimensions.

$\frac{\text{PN (bar)}}{10} = \text{PN (MPa)}$

Do not create drawings from these dimensions, they are subject to change and ISO manufacturing allowances.