

## DIN fittings

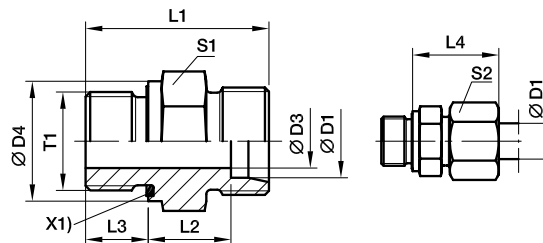

### GE-M-ED Male stud connector

Male metric thread – ED (ISO 9974) / EO 24° cone end



X1) Elastic-sealing ED

Series	D1	T1	D3	D4	L1	L2	L3	L4	S1	S2	Weight g/1 piece	Order code*	PN (bar) <sup>1)</sup>	
													CF	71
L <sup>3)</sup>	06	M 10×1.0	4	14	23.5	8.5	8	23	14	14	13	<b>GE06LMEDOMD</b>	500	315
	08	M 12×1.5	6	17	29.0	10.0	12	25	17	17	22	<b>GE08LMEDOMD</b>	500	315
	10	M 14×1.5	7	19	30.0	11.0	12	26	19	19	29	<b>GE10LMEDOMD</b>	500	315
	10	M 12×1.5	6	17	30.0	11.0	12	26	17	19	23	<b>GE10LM12X1.5EDOMD</b>	315	315
	10	M 16×1.5	8	22	31.5	12.5	12	24	22	19	40	<b>GE10LM16X1.5EDOMD</b>	420	315
	10	M 18×1.5	8	24	31.5	12.5	12	27	24	19	50	<b>GE10LM18X1.5EDOMD</b>	400	315
	10	M 22×1.5	8	27	35.0	14.0	14	29	27	19	80	<b>GE10LM22X1.5EDOMD</b>	400	315
	12	M 16×1.5	9	22	31.5	12.5	12	27	22	22	40	<b>GE12LMEDOMD</b>	400	315
	12	M 14×1.5	7	19	30.0	11.0	12	26	19	22	30	<b>GE12LM14X1.5EDOMD</b>	400	315
	12	M 18×1.5	10	24	31.5	12.5	12	27	24	22	47	<b>GE12LM18X1.5EDOMD</b>	400	315
	12	M 22×1.5	10	27	35.0	14.0	14	29	27	22	75	<b>GE12LM22X1.5EDOMD</b>	400	315
	15	M 18×1.5	11	24	32.5	13.5	12	29	24	27	51	<b>GE15LMEDOMD</b>	400	315
	15	M 16×1.5	9	22	32.0	13.0	12	28	24	27	64	<b>GE15LM16X1.5EDOMD</b>	400	315
	15	M 22×1.5	12	27	36.0	15.0	14	30	27	27	77	<b>GE15LM22X1.5EDOMD</b>	400	315
	18	M 22×1.5	14	27	36.0	14.5	14	31	27	32	74	<b>GE18LMEDOMD</b>	400	315
	18	M 18×1.5	11	24	33.5	14.0	12	30	27	32	68	<b>GE18LM18X1.5EDOMD</b>	400	315
	22	M 26×1.5	18	32	40.0	16.5	16	33	32	36	103	<b>GE22LMEDOMD</b>	250	160
	22	M 22×1.5	14	32	38.0	16.5	14	33	32	36	97	<b>GE22LM22X1.5EDOMD</b>	250	160
28	M 33×2.0	23	40	43.0	17.5	18	34	41	41	168	<b>GE28LMEDOMD</b>	250	160	
35	M 42×2.0	30	50	48.0	17.5	20	39	50	50	281	<b>GE35LMEDOMD</b>	250	160	
42	M 48×2.0	36	55	52.0	19.0	22	42	55	60	356	<b>GE42LMEDOMD</b>	250	160	
S <sup>4)</sup>	06	M 12×1.5	4	17	32.0	13.0	12	28	17	17	30	<b>GE06SMEDOMD</b>	800	630
	08	M 14×1.5	5	19	34.0	15.0	12	30	19	19	42	<b>GE08SMEDOMD</b>	800	630
	10	M 16×1.5	7	22	34.5	15.0	12	31	22	22	54	<b>GE10SMEDOMD</b>	800	630
	12	M 18×1.5	8	24	36.5	17.0	12	33	24	24	71	<b>GE12SMEDOMD</b>	630	630
	12	M 14×1.5	5	19	36.0	16.5	12	33	22	24	60	<b>GE12SM14X1.5EDOMD</b>	630	630
	12	M 22×1.5	8	27	39.0	17.5	14	34	27	24	102	<b>GE12SM22X1.5EDOMD</b>	630	400
	14	M 20×1.5	10	26	41.0	19.0	14	37	27	27	98	<b>GE14SMEDOMD</b>	630	630
	16	M 22×1.5	12	27	41.0	18.5	14	37	27	30	95	<b>GE16SMEDOMD</b>	630	400
	16	M 18×1.5	8	24	38.5	18.0	12	36	27	30	88	<b>GE16SM18X1.5EDOMD</b>	630	400
	20	M 27×2.0	16	32	47.0	20.5	16	42	32	36	150	<b>GE20SMEDOMD</b>	420	400
	25	M 33×2.0	20	40	53.0	23.0	18	47	41	46	264	<b>GE25SMEDOMD</b>	420	400
	30	M 42×2.0	25	50	57.0	23.5	20	50	50	50	422	<b>GE30SMEDOMD</b>	420	400
38	M 48×2.0	32	55	64.0	26.0	22	57	55	60	569	<b>GE38SMEDOMD</b>	420	315	

<sup>1)</sup> Pressure shown = item deliverable

<sup>3)</sup> L = light series; <sup>4)</sup> S = heavy series

$$\frac{\text{PN (bar)}}{10} = \text{PN (MPa)}$$

Delivery without nut and ring. Information on ordering complete fittings or alternative sealing materials see page 17.

\*Please add the below according to the material/surface required.

Order code suffixes			
Material	Suffix surface and material	Example	Standard sealing material (no additional suffix needed)
Steel, zinc plated, Cr(VI)-free	CF	GE16SMEDOMDCF	NBR
Stainless Steel	71	GE16SMEDOMD71	VIT