

## O-Lok®

### F87OMLO Male stud connector

O-Lok® ORFS tube end / Male metric thread – O-ring (ISO 6149-2)  
SAE 52M0187 ISO 8434-3 SDS

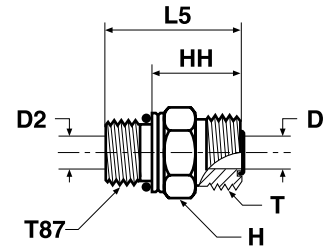

| Tube O.D.  |           | Thread metric T87 | Thread UN/UNF-2A T | D mm | D2 mm | H mm | HH mm | L5 mm | Weight (steel) g/1 piece | O-Lok® Steel  | O-Lok® Stainless Steel | PN (bar) |     |
|------------|-----------|-------------------|--------------------|------|-------|------|-------|-------|--------------------------|---------------|------------------------|----------|-----|
| mm         | in.       |                   |                    |      |       |      |       |       |                          |               |                        | S        | SS  |
| 6          | 1/4       | M 10×1.0          | 9/16-18            | 4.5  | 3     | 17   | 18    | 27    | 20                       | 4M10F87OMLOS  | 4M10F87OMLOSS          | 630      | 630 |
| 6          | 1/4       | M 12×1.5          | 9/16-18            | 4.5  | 4     | 17   | 18    | 29    | 24                       | 4M12F87OMLOS  | 4M12F87OMLOSS          | 630      | 630 |
| 6          | 1/4       | M 14×1.5          | 9/16-18            | 4.5  | 4.5   | 19   | 19    | 30    | 30                       | 4M14F87OMLOS  | 4M14F87OMLOSS          | 630      | 630 |
| 6          | 1/4       | M 16×1.5          | 9/16-18            | 4.5  | 7     | 22   | 20    | 33    | 35                       | 4M16F87OMLOS  | 4M16F87OMLOSS          | 630      | 630 |
| 8, 10      | 5/16, 3/8 | M 12×1.5          | 11/16-16           | 6.5  | 4     | 19   | 21    | 32    | 40                       | 6M12F87OMLOS  | 6M12F87OMLOSS          | 630      | 630 |
| 8, 10      | 5/16, 3/8 | M 14×1.5          | 11/16-16           | 6.5  | 6     | 19   | 21    | 32    | 43                       | 6M14F87OMLOS  | 6M14F87OMLOSS          | 630      | 630 |
| 8, 10      | 5/16, 3/8 | M 16×1.5          | 11/16-16           | 6.5  | 6.5   | 22   | 21    | 34    | 43                       | 6M16F87OMLOS  | 6M16F87OMLOSS          | 630      | 630 |
| 8, 10      | 5/16, 3/8 | M 18×1.5          | 11/16-16           | 6.5  | 9     | 24   | 22    | 36    | 45                       | 6M18F87OMLOS  | 6M18F87OMLOSS          | 630      | 630 |
| 8, 10      | 5/16, 3/8 | M 22×1.5          | 11/16-16           | 6.5  | 6.5   | 27   | 23    | 38    | 52                       | 6M22F87OMLOS  | 6M22F87OMLOSS          | 420      | 420 |
| 12         | 1/2       | M 14×1.5          | 13/16-16           | 9.5  | 6     | 22   | 24    | 35    | 40                       | 8M14F87OMLOS  | 8M14F87OMLOSS          | 630      | 630 |
| 12         | 1/2       | M 16×1.5          | 13/16-16           | 9.5  | 7     | 22   | 24    | 37    | 58                       | 8M16F87OMLOS  | 8M16F87OMLOSS          | 630      | 630 |
| 12         | 1/2       | M 18×1.5          | 13/16-16           | 9.5  | 9     | 24   | 24    | 38    | 55                       | 8M18F87OMLOS  | 8M18F87OMLOSS          | 630      | 630 |
| 12         | 1/2       | M 22×1.5          | 13/16-16           | 9.5  | 9.5   | 27   | 24    | 39    | 60                       | 8M22F87OMLOS  | 8M22F87OMLOSS          | 420      | 420 |
| 12         | 1/2       | M 27×2.0          | 13/16-16           | 9.5  | 9.5   | 32   | 26    | 44    | 70                       | 8M27F87OMLOS  | 8M27F87OMLOSS          | 420      | 420 |
| 14, 15, 16 | 5/8       | M 18×1.5          | 1-14               | 12.5 | 9     | 27   | 27    | 41    | 120                      | 10M18F87OMLOS | 10M18F87OMLOSS         | 420      | 420 |
| 14, 15, 16 | 5/8       | M 22×1.5          | 1-14               | 12.5 | 12    | 27   | 27    | 42    | 127                      | 10M22F87OMLOS | 10M22F87OMLOSS         | 420      | 420 |
| 14, 15, 16 | 5/8       | M 27×2.0          | 1-14               | 12.5 | 13    | 32   | 29    | 47    | 177                      | 10M27F87OMLOS | 10M27F87OMLOSS         | 420      | 420 |
| 18, 20     | 3/4       | M 22×1.5          | 1 3/16-12          | 15.5 | 12    | 32   | 30    | 45    | 170                      | 12M22F87OMLOS | 12M22F87OMLOSS         | 420      | 420 |
| 18, 20     | 3/4       | M 27×2.0          | 1 3/16-12          | 15.5 | 15    | 32   | 30    | 49    | 187                      | 12M27F87OMLOS | 12M27F87OMLOSS         | 420      | 420 |
| 18, 20     | 3/4       | M 33×2.0          | 1 3/16-12          | 15.5 | 20    | 41   | 33    | 52    | 200                      | 12M33F87OMLOS | 12M33F87OMLOSS         | 420      | 420 |
| 22, 25     | 1         | M 27×2.0          | 1 7/16-12          | 20.5 | 15    | 41   | 34    | 52    | 230                      | 16M27F87OMLOS | 16M27F87OMLOSS         | 420      | 420 |
| 22, 25     | 1         | M 33×2.0          | 1 7/16-12          | 20.5 | 20    | 41   | 34    | 52    | 270                      | 16M33F87OMLOS | 16M33F87OMLOSS         | 420      | 280 |
| 28, 30, 32 | 1 1/4     | M 33×2.0          | 1 11/16-12         | 26   | 20    | 46   | 36    | 54    | 370                      | 20M33F87OMLOS | 20M33F87OMLOSS         | 420      | 280 |
| 28, 30, 32 | 1 1/4     | M 42×2.0          | 1 11/16-12         | 26   | 26    | 50   | 36    | 55    | 390                      | 20M42F87OMLOS | 20M42F87OMLOSS         | 420      | 280 |
| 35, 38     | 1 1/2     | M 42×2.0          | 2-12               | 32   | 26    | 55   | 36    | 55    | 400                      | 24M42F87OMLOS | 24M42F87OMLOSS         | 350      | 280 |
| 35, 38     | 1 1/2     | M 48×2.0          | 2-12               | 32   | 32    | 55   | 36    | 57    | 412                      | 24M48F87OMLOS | 24M48F87OMLOSS         | 350      | 280 |
| 50         | 2         | M 60×2.0          | 2 1/2-12           | 40   | 40    | 65   | 41    | 65    | 800                      | 32M60F87OMLOS | 32M60F87OMLOSS         | 200      | 280 |

Product delivered with NBR TRAP seal. Replacement of TRAP seal is with a standard NBR O-ring – see page J74–J75.

Part numbers shown are part of our current manufacturing programme.

Imperial and metric parts may vary in hexagon dimensions.

$$\frac{\text{PN (bar)}}{10} = \text{PN (MPa)}$$

Do not create drawings from these dimensions, they are subject to change and ISO manufacturing allowances.