

## Triple-Lok®

### C4OMX Male stud elbow

Triple-Lok® 37° Flare end / Adjustable BSPP thread O-ring + retaining ring (ISO 1179)

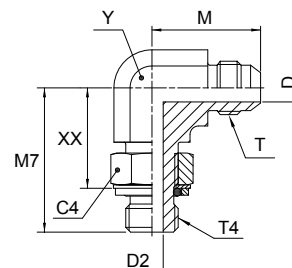

Tube O.D.		Thread BSPP T4	Thread UN/UNF-2A T	C4 mm	D mm	D2 mm	M mm	M7 mm	XX mm	Y mm	Weight (steel) g/1 piece	Triple-Lok® Steel	Triple-Lok® Stainless Steel	PN (bar)	
mm	in.													S	SS
6	1/4	1/8-28	7/16-20	14	4.4	4.4	23	27	19	11	37	<b>4C4OMXS</b>	<b>4C4OMXS</b>	250	250
6	1/4	1/4-19	7/16-20	19	4.4	7.5	27	32	21	14	43	<b>4-4C4OMXS</b>	<b>4-4C4OMXS</b>	250	200
6	1/4	3/8-19	7/16-20	22	4.4	9.9	29	37	26	19	50	<b>4-6C4OMXS</b>	<b>4-6C4OMXS</b>	250	200
8	5/16	1/8-28	1/2-20	14	6	4.4	24	27	19	13	47	<b>5C4OMXS</b>	<b>5C4OMXS</b>	250	250
8	5/16	1/4-19	1/2-20	19	6	7.5	27	32	21	14	55	<b>5-4C4OMXS</b>	<b>5-4C4OMXS</b>	250	200
8	5/16	3/8-19	1/2-20	22	6	9.9	29	37	26	19	57	<b>5-6C4OMXS</b>	<b>5-6C4OMXS</b>	250	200
10	3/8	1/4-19	9/16-18	19	7.5	7.5	27	32	21	14	61	<b>6C4OMXS</b>	<b>6C4OMXS</b>	250	200
10	3/8	1/8-28	9/16-18	14	7.5	4.4	27	28	19	14	52	<b>6-2C4OMXS</b>	<b>6-2C4OMXS</b>	250	200
10	3/8	3/8-19	9/16-18	22	7.5	9.9	29	37	26	19	95	<b>6-6C4OMXS</b>	<b>6-6C4OMXS</b>	250	200
10	3/8	1/2-14	9/16-18	27	7.5	12.3	31	43	29	22	80	<b>6-8C4OMXS</b>	<b>6-8C4OMXS</b>	250	200
12	1/2	3/8-19	3/4-16	22	9.9	9.9	32	37	27	19	102	<b>8C4OMXS</b>	<b>8C4OMXS</b>	250	200
12	1/2	1/4-19	3/4-16	19	9.9	7.5	32	37	26	19	91	<b>8-4C4OMXS</b>	<b>8-4C4OMXS</b>	250	200
12	1/2	1/2-14	3/4-16	27	9.9	12.3	34	43	29	22	155	<b>8-8C4OMXS</b>	<b>8-8C4OMXS</b>	250	200
12	1/2	3/4-14	3/4-16	36	9.9	15.5	36	50	35	27	205	<b>8-12C4OMXS</b>	<b>8-12C4OMXS</b>	250	200
14, 15, 16	5/8	1/2-14	7/8-14	27	12.3	12.3	37	43	29	22	164	<b>10C4OMXS</b>	<b>10C4OMXS</b>	250	200
14, 15, 16	5/8	3/8-19	7/8-14	22	12.3	9.9	37	36	25	22	190	<b>10-6C4OMXS</b>	<b>10-6C4OMXS</b>	250	200
14, 15, 16	5/8	3/4-14	7/8-14	36	12.3	15.5	39	50	35	27	217	<b>10-12C4OMXS</b>	<b>10-12C4OMXS</b>	250	200
18, 20	3/4	3/4-14	1 1/16-12	36	15.5	15.5	42	50	35	27	295	<b>12C4OMXS</b>	<b>12C4OMXS</b>	250	200
18, 20	3/4	1/2-14	1 1/16-12	27	15.5	12.3	42	50	35	27	245	<b>12-8C4OMXS</b>	<b>12-8C4OMXS</b>	250	200
18, 20	3/4	1-11	1 1/16-12	41	15.5	21.5	45	52	35	33	317	<b>12-16C4OMXS</b>	<b>12-16C4OMXS</b>	250	200
25	1	1-11	1 5/16-12	41	21.5	21.5	46	52	36	33	425	<b>16C4OMXS</b>	<b>16C4OMXS</b>	250	200
25	1	3/4-14	1 5/16-12	36	21.5	15.5	46	47	33	33	405	<b>16-12C4OMXS</b>	<b>16-12C4OMXS</b>	250	200
28, 30, 32	1 1/4	1 1/4-11	1 5/8-12	50	27.5	27.5	52	57	41	41	697	<b>20C4OMXS</b>	<b>20C4OMXS</b>	210	160
28, 30, 32	1 1/4	1-11	1 5/8-12	41	21.5	27.5	52	57	41	41	650	<b>20-16C4OMXS</b>	<b>20-16C4OMXS</b>	250	160
35, 38	1 1/2	1 1/2-11	1 7/8-12	55	33	33	59	61	45	48	953	<b>24C4OMXS</b>	<b>24C4OMXS</b>	140	140
35, 38	1 1/2	1 1/4-11	1 7/8-12	50	33	27.5	59	61	45	48	964	<b>24-20C4OMXS</b>	<b>24-20C4OMXS</b>	210	140

Steel, stainless steel and brass Triple-Lok® parts are delivered with NBR elastomeric seals as standard. For more details on other seal materials see page K92.

Order codes shown are part of our current manufacturing programme.

Imperial and metric parts may vary in hexagon dimensions.

$\frac{PN \text{ (bar)}}{10} = PN \text{ (MPa)}$

Do not create drawings from these dimensions, they are subject to change and ISO manufacturing allowances.