

European Profile

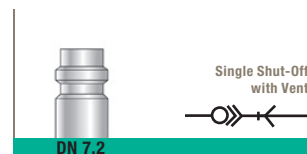

9401E Coupler, Male BSPP Thread

	Technical polymer, nickel-plated brass, NBR 	$\overline{\text{DN}}$	C		E	F	G	L	kg
			G1/4	9401E07 13	6.5	22	36.5	80	0.124
		7.2	G3/8	9401E07 17	7.5	22	36.5	81	0.122
			G1/2	9401E07 21	9	25	36.5	83.5	0.136

C 9000 Series: single shut-off = 2000 NI/min

9414E Coupler, Female BSPP Thread

	Technical polymer, nickel-plated brass, NBR 	$\overline{\text{DN}}$	C		E	F	G	L	kg
			G1/4	9414E07 13	12	22	36.5	73	0.118
		7.2	G3/8	9414E07 17	12	22	36.5	73	0.109
			G1/2	9414E07 21	15	27	36.5	78	0.130

C 9000 Series: single shut-off = 2000 NI/min

9410E Coupler, LF 3000® Push-In Connection, with Spiral Protection Spring

	Technical polymer, nickel-plated brass, NBR 	$\overline{\text{DN}}$	ØD		G	L	L1	kg
			10	9410E07 10	36.5	151	63	0.175
		7.2	12	9410E07 12	36.5	151	63	0.180

C 9000 Series: single shut-off = 2000 NI/min

9421E Coupler with Hosetail

	Technical polymer, nickel-plated brass, NBR 	$\overline{\text{DN}}$	ØD		F	G	L	L1	kg
			8	9421E07 08	22	36.5	93	26	0.113
		7.2	10	9421E07 10	22	36.5	93	26	0.114
			13	9421E07 13	22	36.5	97	30	0.119

C 9000 Series: single shut-off = 2000 NI/min

9416E Coupler, Bulkhead Mountable, Female BSPP Thread

	Technical polymer, nickel-plated brass, NBR 	$\overline{\text{DN}}$	C		E	F	G	K _{max}	L1	L2	ØT _{min}	kg
		7.2	G3/8	9416E07 17	12	24	36.5	7	14.5	74	22.5	0.153

C 9000 Series: single shut-off = 2000 NI/min

Polymer C 9000 Safety

Quick-Acting Couplers

European Profile

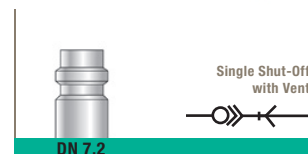

9440E Y Coupler, Female BSPP Thread



Technical polymer, nickel-plated brass, NBR

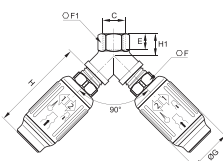

DN	C		E	F	F1	G	H	H1	kg
7.2	G1/2	9440E07 21	14	25	25	36.5	78	19	0.335

C 9000 Series: single shut-off = 2000 NI/min

9087E Probe, Straight-Through, Male BSPP Thread



Nickel-plated steel, technical polymer

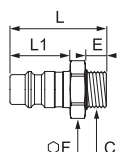

DN	C		E	F	L	L1	kg
7.2	G1/4	9087E07 13	9	14	34	20	0.018
	G3/8	9087E07 17	9	17	34	20	0.025
	G1/2	9087E07 21	12	22	38	20	0.048

Probe without shut-off

9086E Probe, Straight-Through, Female BSPP Thread



Nickel-plated steel

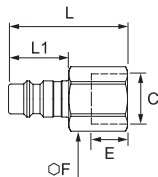

DN	C		E	F	L	L1	kg
7.4	G1/8	9086 25 10	7	14	32	20	0.015
	G1/4	9086 25 13	9	17	38.5	20	0.027
	G3/8	9086 25 17	9	19	33	20	0.027
	G1/2	9086 25 21	12	24	36	20	0.050

Probe without shut-off

9080E Probe, Straight-Through, LF 3000® Push-In Connection, with Spiral Protection Spring



Nickel-plated steel, NBR

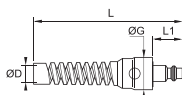

DN	ØD		G	L	L1	kg
7.2	10	9080E07 10	24	114	20	0.102
	12	9080E07 12	29.5	125	20	0.088

Probe without shut-off

9094E Probe, Straight-Through, with Hosetail



Nickel-plated steel

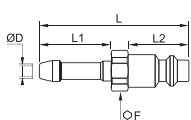

DN	ØD		F	L	L1	L2	kg
7.2	8	9094E07 08	17	48	20	25	0.014
	10	9094E07 10	17	48	20	25	0.016
	13	9094E07 13	17	48	20	25	0.019

Probe without shut-off

C 9000 Polymer Quick-Acting Safety Couplers

This range of ergonomic polymer couplers has been designed for **the safety of operators and machinery** while giving very high **energy efficiency performance**. Available in three profile standards, it is perfectly suited for any type of installation.

Product Advantages

Safety & Reliability

- Prevents risk of whiplash
- Quick-acting vent allowing disconnection to be carried out in total safety
- Rotating sleeve to avoid risk of accidental disconnection
- Low connection/disconnection force even under pressure
- Polymer sleeve protects equipment from scratching
- Protective spiral over the tube prevents kinking

Performance

- Very high flow and low pressure drop
- 100% leak-tested in production
- Date coding to guarantee quality and traceability
- Robust impact-resistant material
- Optimum energy efficiency
- Long-term reliability

Easy-to-Use

- Immediate identification by clear marking on each model showing:
 - profile of the compatible male probe
 - type part number
- Compatible with male probes conforming to:
 - ISO B profile
 - European profile
 - ARO profile



Applications

- Workshops
- Cleaning
- Blowing
- Pneumatics
- Air-Operated Tools
- Ring Main Circuits
- Packaging

Technical Characteristics

Compatible Fluids	Compressed air
Working Pressure	0 to 16 bar
Working Temperature	-20°C to +60°C

Regulations

DI: 97/23/EC (PED)
 DI: 2002/95/EC (RoHS), 2011/65/EC
 DI: 1907/2006 (REACH)
 ISO 4414 Pneumatic Fluid Power: General Rules Relating to Systems
 DIN EN 983 Safety Standard for Pneumatics

Component Materials

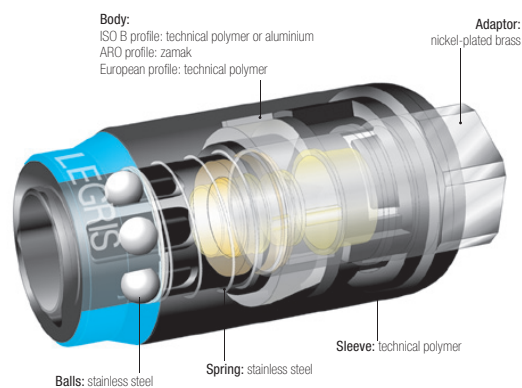

Silicone-free

C 9000 Polymer Quick-Acting Safety Couplers

C 9000 Technology and Flow Rates

"Typical" quick-acting coupler
Standard "poppet" technology
Flow: 1400 NI/min

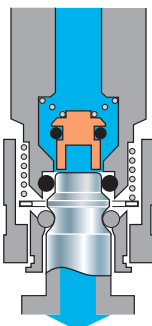

C 9000 quick-acting coupler
"Optimal flow" technology
Flow: 2400 NI/min

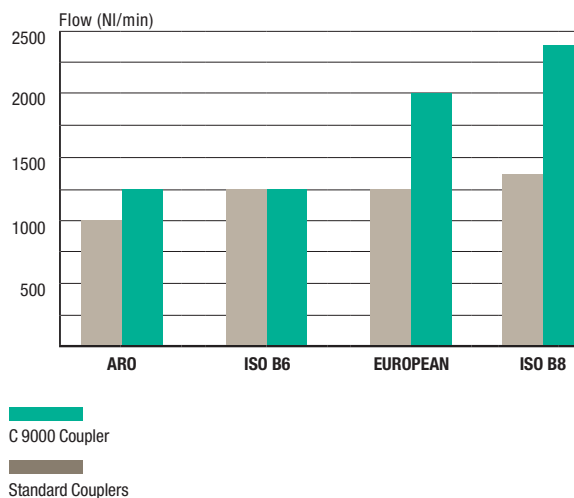
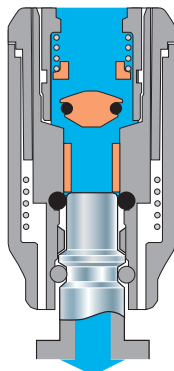

Measurements carried out in accordance with ISO 6358 at a pressure of 6 bar, pressure drop < 0.7 bar

Operation

Operation

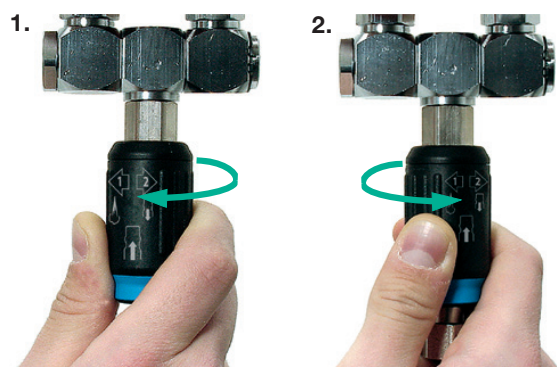

Disconnecting the probe

Rotation, arrow 1: circuit vented on probe side.

Rotation, arrow 2: probe disconnected from the body.

Connecting the probe

The sleeve does not need to be rotated to connect the probe.

Venting



ISO B6 profile, recoil tubing (I.D. 6 mm, length 6 m)

Venting time = 350 ms (transition from 6 bar to 0.2 bar)

ISO B8 profile, PVC tubing (I.D. 10 mm, length 25 m)

Venting time = 860 ms (transition from 6 bar to 0.2 bar)

Even with longer lengths of tubing, the vent time of the C 9000 coupler can be less than 1 second.

Quick-Acting Coupler Part Numbers

