

Stud Fittings

3158 Y Piece, Male BSPP and Metric Thread

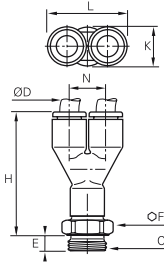

Technical polymer, nickel-plated brass, NBR



	ØD	C		E	F	H	K	L	N	kg
4	M5x0.8	3158 04 19		3.5	8	32.5	8.5	17.5	9	0.006
	G1/8	3158 04 10		5	13	32	8.5	17.5	9	0.009
6	G1/4	3158 04 13		5.5	16	32.5	8.5	17.5	9	0.014
	M5x0.8	3158 06 19		3.5	10	39.5	10.5	21.5	11	0.009
8	G1/8	3158 06 10		5	13	39	10.5	21.5	11	0.012
	G1/4	3158 06 13		5.5	16	39.5	10.5	21.5	11	0.017
10	G1/8	3158 08 10		5	13	49	13.5	28	14.5	0.020
	G1/4	3158 08 13		5.5	16	49.5	13.5	28	14.5	0.023
	G3/8	3158 08 17		6	19	48	13.5	28	14.5	0.030
12	G1/4	3158 10 13		5.5	16	58	16	33	17	0.031
	G3/8	3158 10 17		6	20	57.5	16	33	17	0.039
12	G1/2	3158 10 21		7	24	58	16	33	17	0.053
	G3/8	3158 12 17		6	20	62	19	39	20	0.044
	G1/2	3158 12 21		7	24	63	19	39	20	0.049

The body swivels for positioning purposes.