

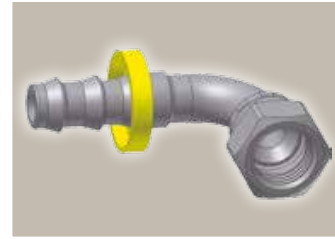

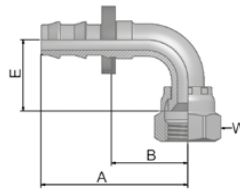

Low Pressure  
SAE

Push-Lok Fittings  
82 Series

**39/3W** Female JIC 37°  
SAE 45° – Dual Flare  
Swivel Female 90° Elbow  
ISO 12151-5-SWES – DKJ 90°



Part Number	 Hose I.D.				 Thread UNF	A mm	B mm	E mm	 W mm <i>Inch</i>
	DN	Inch	Size	mm					
33982-4-4	6	1/4	-4	6.4	7/16x20	39	20	17	5/8
33W82-4-4-SM	6	1/4	-4	6.4	7/16x20	39	20	21	17
33982-6-6	10	3/8	-6	9.5	9/16x18	50	28	22	11/16
33982-6-6-SM	10	3/8	-6	9.5	9/16x18	47	25	23	19
33982-8-8	12	1/2	-8	12.7	3/4x16	59	31	28	7/8
33W82-8-8-SM	12	1/2	-8	12.7	3/4x16	55	29	28	22
33982-10-10	16	5/8	-10	15.9	7/8x14	74	37	31	1
33982-12-12	19	3/4	-12	19.1	1 1/16x12	84	46	46	1 1/4
33982-12-12-SM	19	3/4	-12	19.1	1 1/16x12	88	52	48	32

Also available in stainless steel. Details can be found in CAT 4400.1/UK

Approved **fitting series** for hose types:

**K:** without plastic ring; **B:** Brass; **SM:** Metric Hexagon

**82** 801 804 821FR 830M 831 836 837BM 837PU 838M



B1b-14

Catalogue 4400/UK