

## Parflange® F37 – SAE 3000/ISO 6162-1

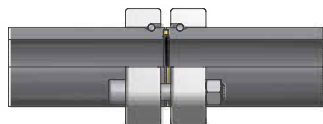

Part combination Bonded seal SAE 3000 connection

Flange pressure (bar)	Size Inch	Pipe Size	Flange	Retaining Ring	Bonded Seal	Bolts Tube to Port	Bolts Tube to Tube	Nut
350	1/2	26X6.0	R-308-CFX	R08X	BS08SNX	4 x ZYLS8X35	4 x ZYLS8X60	4 x ISO4032-M8
	3/4	36X8.0	R-312-CFX	R12X	BS12SNX	4 x ZYLS10X40	4 x ZYLS10X65	4 x ISO4032-M10
	1	39X7.5	R-316-CFX	R16X	BS16SNX	4 x ZYLS10X40	4 x ZYLS10X70	4 x ISO4032-M10
280	1 1/4	46X8.0	R-320-CFX	R20X	BS20SNX	4 x ZYLS10X40	4 x ZYLS10X70	4 x ISO4032-M10
	1 1/2	56X8.5	R-324-CFX	R24X	BS24SNX	4 x ZYLS12X50	4 x ZYLS12X80	4 x ISO4032-M12
	2	66X8.5	R-332-CFX	R32X	BS32SNX	4 x ZYLS12X55	4 x ZYLS12X90	4 x ISO4032-M12
210	2 1/2	80x10.0	R-340-CFX	R40X	BS40SNX	4 x ZYLS12X65	4 x ZYLS12X120	4 x ISO4032-M12
	3	97X12.0	R-348-CFX	R48X	BS48SNX	4 x ZYLS16X80	4 x ZYLS16X130	4 x ISO4032-M16