

Parflange® F37 – SAE 3000/ISO 6162-1

TF – TEE flange

SAE 3000/ISO 6162-1

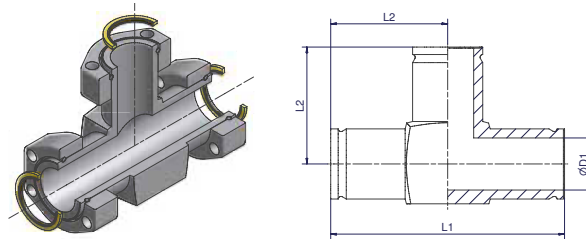

Size Inch	Complete Part Order code	Tee Flange body Order code	D1	L1	L2	Weight body (Steel) kg/1 piece
1/2	R-308TFCF	TF08CFX	14	120	60	0.75
3/4	R-312TFCF	TF12CFX	20	130	65	1.60
1	R-316TFCF	TF16CFX	24	140	70	2.00
1 1/4	R-320TFCF	TF20CFX	30	180	90	2.03
1 1/2	R-324TFCF	TF24CFX	39	200	100	3.13
2	R-332TFCF	TF32CFX	49	220	110	4.53
3	R-348TFCF	TF48CFX	73	320	160	12.81

Other sizes on request

Please change suffixes according to material/surface required

Order code suffixes		
Material	Suffix surface and material	Example
Steel, zinc plated, Cr(VI)-free	CF	R-320TFCF
Stainless steel	SS	R-320TFSS

