

Parflange® F37 – ISO 6164

TT – Flare Flange Connection

Tube to tube connection

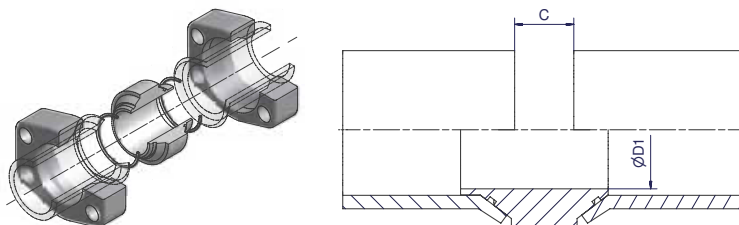

Size		2 Flange incl. Insert + 2 x O-Ring (2 x Sleeve) Order code	D1	C	Insert incl. 2 x O-Ring Order code	O-Ring Order code	Sleeve	Weight (Steel) kg/1 piece
Inch	Tube							
2	50X3.0	F37-432-50X3.0TTCF	42	22	IN32-50X3.0TTCF	OR44.17X1.78X	SL32-60-50-CFX	2.22
2	50X5.0	F37-432-50X5.0TTCF	38	20	IN32-50X5.0TTCF	OR41X1.78X	SL32-60-50-CFX	2.33
2	50X6.0	F37-432-50X6.0TTCF	35	20	IN32-50X6.0TTCF	OR41X1.78X	SL32-60-50-CFX	2.38
2	60X3.0	F37-432-60X3.0TTCF	46	24	IN32-60X3.0TTCF	OR53.7X1.78X		2.35
2	60X5.0	F37-432-60X5.0TTCF	46	22	IN32-60X5.0TTCF	OR50.52X1.78X		2.28
2	60X6.0	F37-432-60X6.0TTCF	46	22	IN32-60X6.0TTCF	OR47.37X1.78X		2.27
2 1/2	60X3.0	F37-440-60X3.0TTCF	50	24	IN40-60X3.0TTCF	OR53.7X1.78X	SL40-75-60-CFX	3.35
2 1/2	60X5.0	F37-440-60X5.0TTCF	46	22	IN40-60X5.0TTCF	OR50.52X1.78X	SL40-75-60-CFX	3.36
2 1/2	60X6.0	F37-440-60X6.0TTCF	45	22	IN40-60X6.0TTCF	OR47.37X1.78X	SL40-75-60-CFX	3.34
2 1/2	73X7.0	F37-440-73X7.0TTCF	56	26	IN40-73X7.0TTCF	OR63.22X1.78X	SL440-73	3.33
2 1/2	75X3.0	F37-440-75X3.0TTCF	60	20	IN40-75X3.0TTCF	OR69.57X1.78X		3.30
2 1/2	75X5.0	F37-440-75X5.0TTCF	60	20	IN40-75X5.0TTCF	OR63.22X1.78X		3.32
3	75X3.0	F37-448-75X3.0TTCF	66	20	IN48-75X3.0TTCF	OR69.57X1.78X	SL48-90-75-CFX	5.83
3	75X5.0	F37-448-75X5.0TTCF	62	20	IN48-75X5.0TTCF	OR63.22X1.78X	SL48-90-75-CFX	5.99
3	90X3.5	F37-448-90X3.5TTCF	72	30	IN48-90X3.5TTCF	OR82.27X1.78X		6.00
3	90X5.0	F37-448-90X5.0TTCF	72	28	IN48-90X5.0TTCF	OR79X1.78X		5.96
3	90X9.0	F37-448-90X9.0TTCF	69	34	IN48-90X9.0TTCF	OR72.75X1.78X	SL4480-90	5.85

Please change suffixes according to material/surface required

Order code suffixes		
Material	Suffix surface and material	Example
Steel, zinc plated, Cr(VI)-free	CF	IN32-50X5.0TTCF
Stainless steel	SS	IN32-50X5.0TTSS

