

Parflange® F37 – ISO 6164

TF – Flare Flange Connection

Tube to port connection, flat face

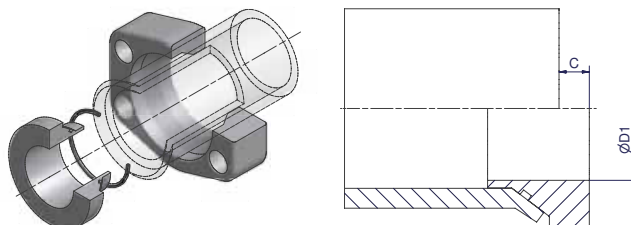

Size		Flange incl. Insert + O-Ring Order code	D1	C	Insert incl. O-Ring Order code	O-Ring Order code	Sleeve	Weight (Steel) kg/1 piece
Inch	Tube							
2	50X3.0	F37-432-50X3.0TFCF	42	11	IN32-50X3.0TFCF	OR44.17X1.78X	SL32-60-50-CFX	2.02
2	50X5.0	F37-432-50X5.0TFCF	38	10	IN32-50X5.0TFCF	OR41X1.78X	SL32-60-50-CFX	2.04
2	50X6.0	F37-432-50X6.0TFCF	35	10	IN32-50X6.0TFCF	OR41X1.78X	SL32-60-50-CFX	2.07
2	60X3.0	F37-432-60X3.0TFCF	46	12	IN32-60X3.0TFCF	OR53.7X1.78X		2.07
2	60X5.0	F37-432-60X5.0TFCF	46	11	IN32-60X5.0TFCF	OR50.52X1.78X		2.04
2	60X6.0	F37-432-60X6.0TFCF	46	11	IN32-60X6.0TFCF	OR47.37X1.78X		2.03
2 1/2	60X3.0	F37-440-60X3.0TFCF	50	12	IN40-60X3.0TFCF	OR53.7X1.78X	SL40-75-60-CFX	3.35
2 1/2	60X5.0	F37-440-60X5.0TFCF	46	11	IN40-60X5.0TFCF	OR50.52X1.78X	SL40-75-60-CFX	3.36
2 1/2	60X6.0	F37-440-60X6.0TFCF	46	11	IN40-60X6.0TFCF	OR47.37X1.78X	SL40-75-60-CFX	3.34
2 1/2	73X7.0	F37-440-73X7.0TFCF	56	13	IN40-73X7.0TFCF	OR63.22X1.78X	SL440-73	3.33
2 1/2	75X3.0	F37-440-75X3.0TFCF	60	10	IN40-75X3.0TFCF	OR69.57X1.78X		3.30
2 1/2	75X5.0	F37-440-75X5.0TFCF	60	10	IN40-75X5.0TFCF	OR63.22X1.78X		3.32
3	75X3.0	F37-448-75X3.0TFCF	66	10	IN48-75X3.0TFCF	OR69.57X1.78X	SL48-90-75-CFX	5.83
3	75X5.0	F37-448-75X5.0TFCF	62	10	IN48-75X5.0TFCF	OR63.22X1.78X	SL48-90-75-CFX	5.99
3	90X3.5	F37-448-90X3.5TFCF	72	15	IN48-90X3.5TFCF	OR82.27X1.78X		6.00
3	90X5.0	F37-448-90X5.0TFCF	72	14	IN48-90X5.0TFCF	OR79X1.78X		5.96
3	90X9.0	F37-448-90X9.0TFCF	69	17	IN48-90X9.0TFCF	OR72.75X1.78X	SL448-90	5.82

Please change suffixes according to material/surface required

Order code suffixes		
Material	Suffix surface and material	Example
Steel, zinc plated, Cr(VI)-free	CF	IN32-50X5.0TFCF
Stainless steel	SS	IN32-50X5.0TFSS

ENGINEERING YOUR SUCCESS.