

## EO-3®-Tube fittings

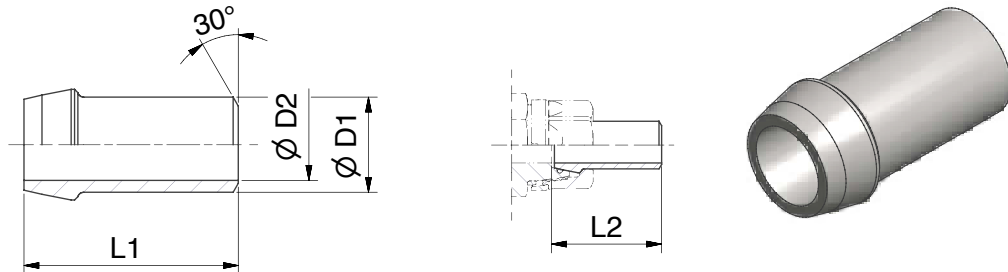

### SKA EO-3® Weld nipple



D1	D2	L1	L2	Weight g/1 piece	Order code*	PN
8	5	27	27.5	8	SKA08X1.5P3X	420
10	7	28.5	29	10	SKA10X1.5P3X	420
10	6	28.5	29	12	SKA10X2P3X	420
12	9	28.5	29	12	SKA12X1.5P3X	420
12	8	28.5	29	14	SKA12X2P3X	420
12	7	28.5	29	16	SKA12X2.5P3X	420
15	11	31.5	32	22	SKA15X2P3X	420
16	12	36	36.5	27	SKA16X2P3X	420
16	11	36	36.5	31	SKA16X2.5P3X	420
16	10	36	36.5	34	SKA16X3P3X	420
18	13	33	33.5	32	SKA18X2.5P3X	420
20	16	39.5	40	38	SKA20X2P3X	420
20	15	39.5	40	46	SKA20X2.5P3X	420
20	14	39.5	40	51	SKA20X3P3X	420
20	12	39.5	40	60	SKA20X4P3X	420
22	17	35	35.5	45	SKA22X2.5P3X	250
25	19	46	46.5	80	SKA25X3P3X	420
25	17	46	46.5	96	SKA25X4P3X	420
25	15	46	46.5	109	SKA25X5P3X	420
28	23	40	40.5	67	SKA28X2.5P3X	250
28	22	40	40.5	75	SKA28X3P3X	250
30	22	50	50.5	129	SKA30X4P3X	420
30	20	50	50.5	148	SKA30X5P3X	420
35	28	44	44.5	123	SKA35X3.5P3X	250
38	30	55	56	197	SKA38X4P3X	420
38	28	55	56	226	SKA38X5P3X	420
38	26	55	56	252	SKA38X6P3X	420
42	36	44	44.5	136	SKA42X3P3X	250

$$\frac{\text{PN (bar)}}{10} = \text{PN (MPa)}$$

\* Surface phosphated and oiled