

Specifications:

- Steel body
- Side Inlet Port: 7.0" Diameter
- Outlet Ports: 6.0" and 7.0" Diameter
- Flow rates: 645 - 1910 cfm
- Assembly Lengths: 13.0" - 24.0"
- Assembly Diameters: 11.0" - 13.5"
- Long Life Filter

Engine Displacement Formula:

$$CFM = HP \times SA$$

SA = Specific Airflow rating

- 4-Stroke naturally aspirated diesel engine: **SA = 2.0**
- 4-Stroke turbo charged diesel engine: **SA = 2.3**
- 4-Stroke turbo charged after cooled diesel engine: **SA = 2.3**
- 2-Stroke naturally aspirated diesel engine: **SA = 2.0**
- 2-Stroke scavenge blower diesel engine: **SA = 3.3**
- 2-Stroke turbo charged diesel engine: **SA = 3.6**

Dimensions:

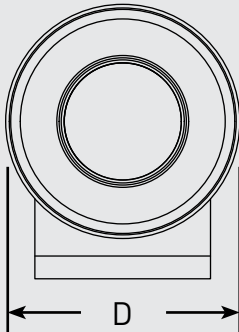

SIDE INLET ASSEMBLY	(A) INLET OD IN (CM)	(B) OUTLET ID IN (CM)	(C) LENGTH IN (CM)	(D) DIAMETER IN (CM)	(E) DISTANCE IN (CM)	FLOW RATE CFM	WEIGHT LBS (KG)
400820001	7.0 (17.8)	7.0 (17.8)	24.0 (61.0)	11.0 (27.9)	5.5 (14.0)	985-1475	19.0 (8.6)
400820002	7.0 (17.8)	7.0 (17.8)	24.0 (61.0)	11.0 (27.9)	12.0 (30.5)	905-1340	19.0 (8.6)
400820003	7.0 (17.8)	7.0 (17.8)	24.0 (61.0)	11.0 (27.9)	18.5 (47.0)	645-950	19.0 (8.6)
400820004	7.0 (17.8)	7.0 (17.8)	24.0 (61.0)	13.5 (34.3)	5.5 (14.0)	1295-1910	21.5 (9.8)
400820006	7.0 (17.8)	7.0 (17.8)	24.0 (61.0)	13.5 (34.3)	18.5 (47.0)	845-1250	21.5 (9.8)
400820014	7.0 (17.8)	7.0 (17.8)	18.0 (45.7)	11.0 (27.9)	5.5 (14.0)	970-1455	13.5 (6.1)
400820015	7.0 (17.8)	7.0 (17.8)	18.0 (45.7)	11.0 (27.9)	12.5 (31.8)	715-1075	13.5 (6.1)
400820019	7.0 (17.8)	7.0 (17.8)	13.0 (33.0)	11.0 (27.9)	7.5 (19.1)	710-1100	10.2 (4.6)
400820020	7.0 (17.8)	7.0 (17.8)	15.0 (38.1)	11.0 (27.9)	7.5 (19.1)	820-1230	11.5 (5.2)
400820021	7.0 (17.8)	6.0 (15.2)	15.0 (38.1)	11.0 (27.9)	7.5 (19.1)	740-1100	11.5 (5.2)
400820022	7.0 (17.8)	6.0 (15.2)	18.0 (45.7)	11.0 (27.9)	12.5 (31.8)	650-960	12.8 (5.8)
400820023	7.0 (17.8)	6.0 (15.2)	13.0 (33.0)	11.0 (27.9)	7.5 (19.1)	720-1060	10.2 (4.6)
400820026	6.0 (15.2)	6.0 (15.2)	18.0 (45.7)	9.75 (24.7)	4.0 (10.1)	720-1060	10.4 (4.7)

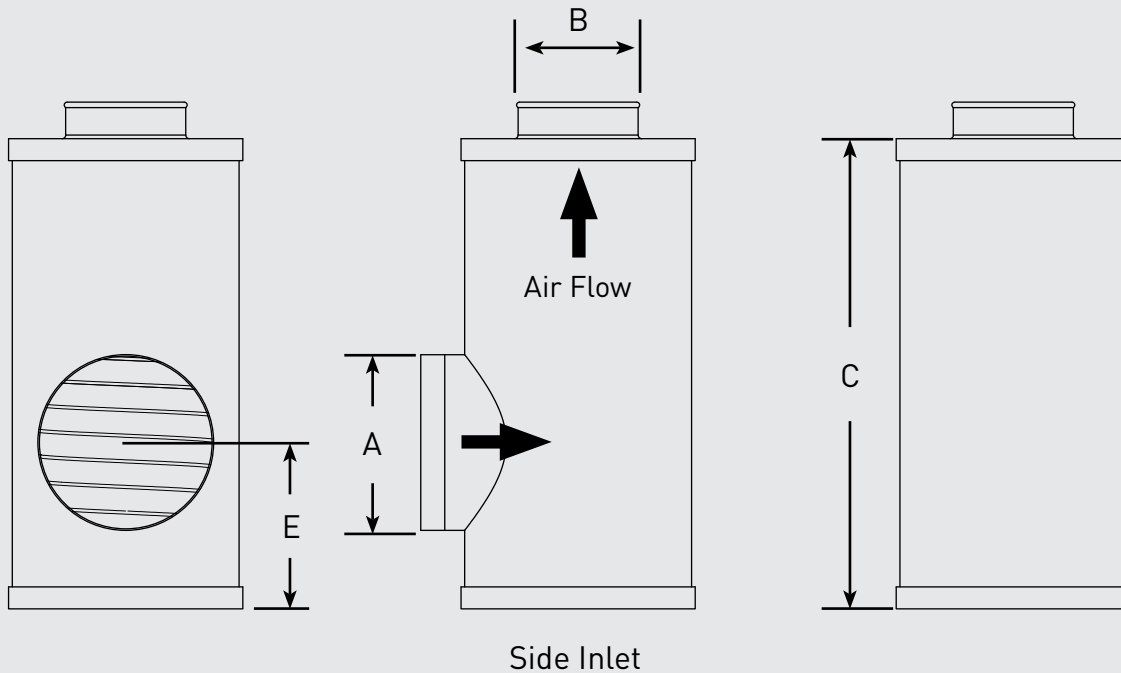

PARTS

ECO-LL Series

1

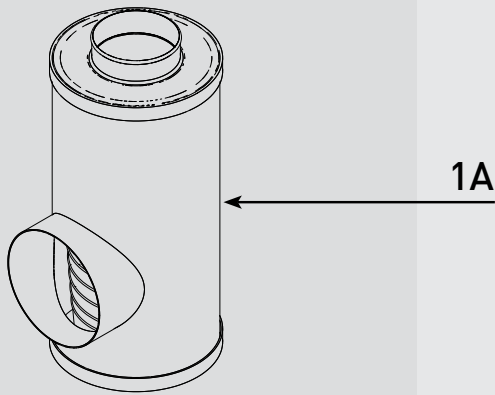

1A

2

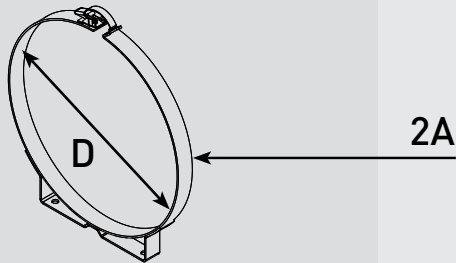

2A

Part #	Description
1A 400820001	Side Inlet - (D) 11.0 in., (L) 24.0 in., (OD) 7.0 in., (ID) 7.0 in., (Inlet Port Location from Base) 5.5 in.
400820002	Side Inlet - (D) 11.0 in., (L) 24.0 in., (OD) 7.0 in., (ID) 7.0 in., (Inlet Port Location from Base) 12.0 in.
400820003	Side Inlet - (D) 11.0 in., (L) 24.0 in., (OD) 7.0 in., (ID) 7.0 in., (Inlet Port Location from Base) 18.5 in.
400820004	Side Inlet - (D) 13.5 in., (L) 24.0 in., (OD) 7.0 in., (ID) 7.0 in., (Inlet Port Location from Base) 5.5 in.
400820006	Side Inlet - (D) 13.5 in., (L) 24.0 in., (OD) 7.0 in., (ID) 7.0 in., (Inlet Port Location from Base) 18.5 in.
400820014	Side Inlet - (D) 11.0 in., (L) 18.0 in., (OD) 7.0 in., (ID) 7.0 in., (Inlet Port Location from Base) 5.5 in.
400820015	Side Inlet - (D) 11.0 in., (L) 18.0 in., (OD) 7.0 in., (ID) 7.0 in., (Inlet Port Location from Base) 12.5 in.
400820019	Side Inlet - (D) 11.0 in., (L) 13.0 in., (OD) 7.0 in., (ID) 7.0 in., (Inlet Port Location from Base) 7.5 in.
400820020	Side Inlet - (D) 11.0 in., (L) 15.0 in., (OD) 7.0 in., (ID) 7.0 in., (Inlet Port Location from Base) 7.5 in.
400820021	Side Inlet - (D) 11.0 in., (L) 15.0 in., (OD) 6.0 in., (ID) 7.0 in., (Inlet Port Location from Base) 7.5 in.
400820022	Side Inlet - (D) 11.0 in., (L) 18.0 in., (OD) 6.0 in., (ID) 7.0 in., (Inlet Port Location from Base) 12.5 in.
400820023	Side Inlet - (D) 11.0 in., (L) 13.0 in., (OD) 6.0 in., (ID) 7.0 in., (Inlet Port Location from Base) 7.5 in.
400820026	Side Inlet - (D) 9.75.0 in., (L) 18.0 in., (OD) 6.0 in., (ID) 6.0 in., (Inlet Port Location from Base) 4.0 in.
2A 071921001	Mounting Clamp - (D) 9.8 in.
071921002	Mounting Clamp - (D) 11.0 in.
071921003	Mounting Clamp - (D) 13.5 in.

Online Link
Disposasable Engine Air Filters Product Selector



RSL0391_CUT_ECO-LL (03/25 Rev A)

Questions? Email: racortech@parker.com Phone: 800-344-3286 News: www.racornews.com