

Parker Chelsea PTO Switch Bracket Update

Parker Chelsea Products Division would like to announce an updated version of our PTO switch bracket, **assembly PN 380668X**. This part will replace legacy bracket PN 379336. This new switch bracket features a more compact design, with a PTO engagement light integrated into the rocker switch.

The new rocker switches (PN 75-P-45-12 for 12V circuits and 75-P-45-24 for 24V) utilizes an industry standard panel cutout of 0.830" x 1.450" allowing for integration into body builder consoles.

The transition to this new design began with 280, 870, and 890 Series switch installation kits. As inventory of legacy switch kits depletes, other series will follow in transition.

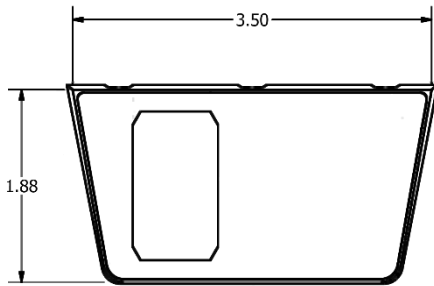

Updated Bracket (PN 380668X)

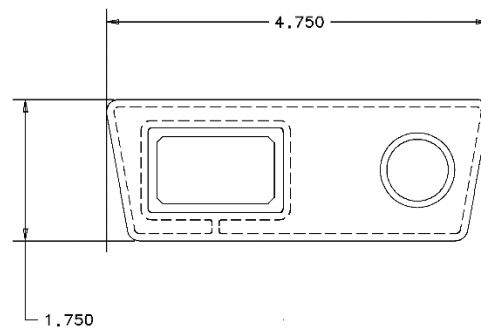

Legacy Bracket (PN 379336)

If you have questions about this bulletin or other technical questions, contact us at:

US: Chelsea Customer/Technical Services **1-888-PH4-TRUK** (1-888-744-8785)
Europe: Parker Hannifin Europe +49 (0) 371 3937 157

Stephen Uszak
Product Manager
Chelsea Products Division
Motion Systems Group