

New 590 Series for Allison TC10

The new 590 Series Power Shift Rear Mount Power Take-Off (P.T.O.) is designed for automatic transmissions that offer a rear mount provision. Current transmission coverage includes Allison TC10 (ALL-20) and Caterpillar CX series (CAT-1, 2 & 3).

The 590 offers simplified installation because there is no backlash to set. The rear mounting position provides excellent clearance for larger pump designs. The 590 is available with 6 direct mount pump flanges. Each features a wet splined pump flange option that will help extend the P.T.O. and pump shaft life up to 10 times its normal life expectancy. Also available is a 1410 companion flange output for remote mounted driven equipment. With an excellent power to weight ratio this P.T.O. is an excellent choice for heavy duty applications.

Versatility, power and ease of maintenance and installation make the 590 Series the only choice for your vocational truck needs.

Markets

- Fire and Rescue
- Refuse
- Sewer Cleaning
- Oil and Gas
- Hydro Excavating

Product Features and Benefits:

- Reduced installation time over side mounted P.T.O.s
- No backlash to set
- Excellent clearance for direct mounted pumps
- Heavy Duty Torque Rating of 650 Lbs.ft. [881Nm] (Continuous & Intermittent Duty Cycles)
- 124 H.P. [93 Kw] at 1000 RPM of shaft speed
- Standard output is a SAE "C" flange and shaft
- All direct mount pump flange options are wet splined for superior shaft life
- Pump Bracket Supplied for mounting large or multiple pumps



If you have questions about this bulletin or other technical questions, contact us at:

US: Chelsea Customer/Technical Services at **1-888-PH4-TRUK** (1-888-744-8785)
Canada: Parker Hannifin Canada, 1 905-693-3020
Europe: Chelsea Products Europe 01 543 483875

Visit our web site at www.chelseaproduct.com for complete information on this new P.T.O. Series or visit our new applications data base web site at www.chelseaptoapps.com.

Walt Harris
Product Sales Manager
Chelsea Products

MODEL NUMBER CHART

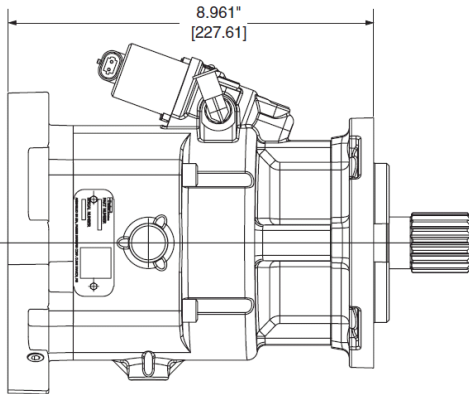
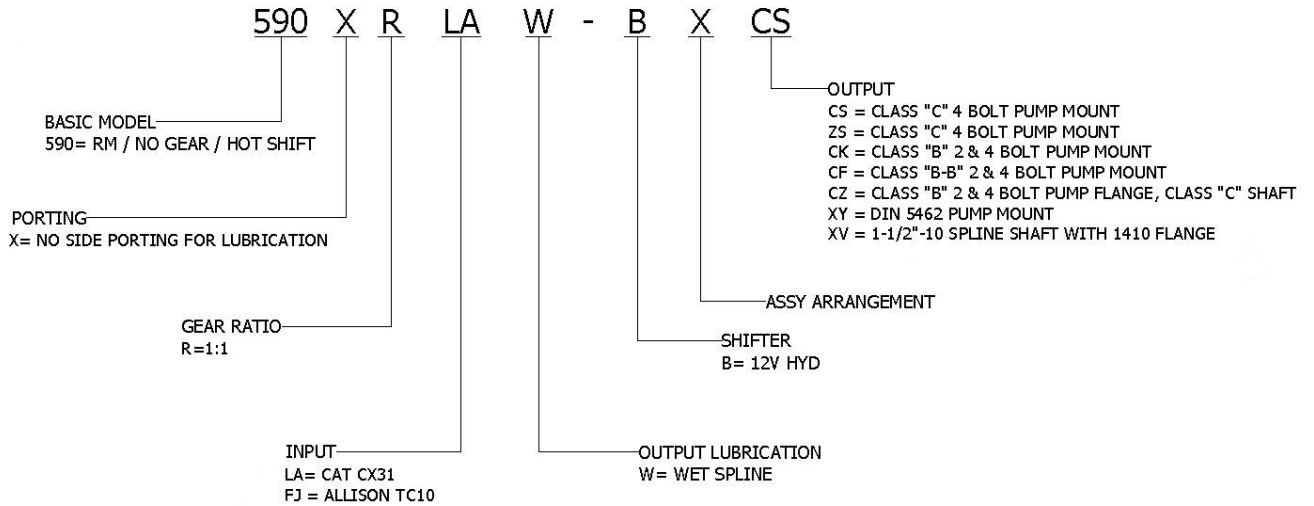

Specifications Chart

590*R	
Standard Output Shaft Size	"CS" S.A.E. "C" 4-Bolt
Continuous Torque Rating (Lbs. ft.)*	650
Continuous Torque Rating (N.m.)	881
Horsepower Rating for Continuous Service	
At 500 R.P.M. of Output Shaft (HP)	62
At 1000 R.P.M. of Output Shaft (HP)	124
At 500 R.P.M. of Output Shaft (Kw)	46
At 1000 R.P.M. of Output Shaft (Kw)	93
Approximate Weight:	50 lbs. [22.8 kg]

*For the 590 Series, 650 Lbs. ft. Torque Rating is for both Intermittent and Continuous, all Output Options.

