

FR1300 Series

Single Stage Pressure Reducing Regulator
Ultra High Purity • High Flow • Stainless Steel



Precise Control, High Flow Performance

The FR1300 Series ultra high purity, pressure reducing regulator offers high-flow capability with an inlet pressure up to 600 psig and is an excellent choice for point of use bulk and specialty gas applications.



Contact Information:

Parker Hannifin Corporation
Veriflo Division
250 Canal Blvd
Richmond, California 94804

phone 510 235 9590
vfo.quotes@support.parker.com
vfo.support@support.parker.com

www.parker.com/veriflo
Mobile App: m.parker.com/veriflo

Product Features:

- 316L stainless steel body
- Passivated & Electropolished
- Manufactured for ultra high purity semiconductor gas applications
- Hastelloy C-22[®] diaphragm
- Metal-to-metal diaphragm seal
- Flows up to 1200 slpm (42 scfm)
- 10 μ m. Ra surface finish



ENGINEERING YOUR SUCCESS.

FR1300 Series

Flow Curves

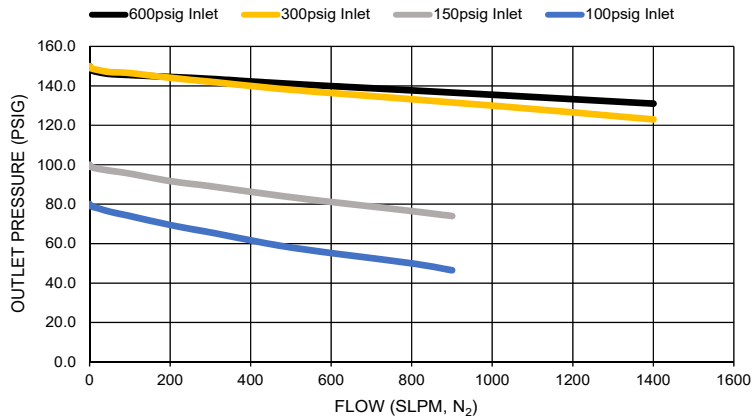

Dimensional Drawings

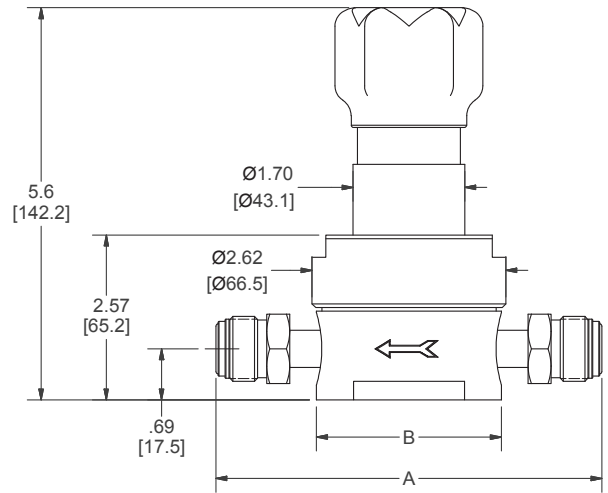

Porting Configurations

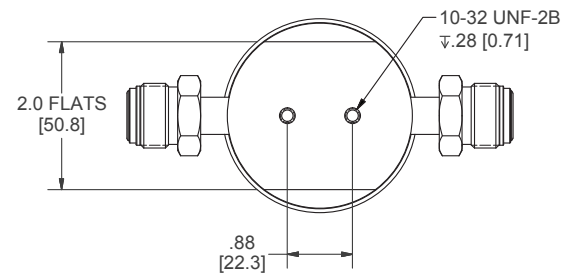
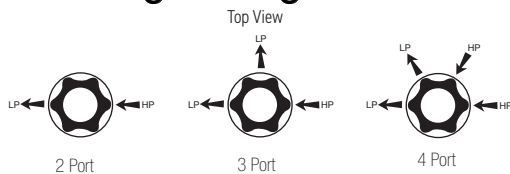

All dimensions in inches. Metric dimensions are for reference only.

DIMENSION TABLE

Connection Type	End to End Dimension (A)	Body Diameter (B)
1/4" Face Seal (male & female)	4.30 in. [109.2 mm]	$\varnothing 2.50$ in. [63.5 mm]
3/8" Face Seal	5.22 in. [132.6 mm]	$\varnothing 2.50$ in. [63.5 mm]
3/8" Tube Stub	4.00 in. [101.6 mm]	$\varnothing 2.50$ in. [63.5 mm]
1/2" Face Seal	5.22 in. [132.6 mm]	$\varnothing 2.50$ in. [63.5 mm]
1/2" Tube Stub	4.34 in. [110.2 mm]	$\varnothing 2.50$ in. [63.5 mm]

Safety Guide and Installation and Operating Instructions available at
www.parker.com/veriflo

FR1300 Series

Ordering Information

Build an FR1300 Series regulator by replacing the numbered symbols with an option from the corresponding tables below.

Contact factory for most up to date lead time information.

Blue = Configurations that have selections in blue will require a price quote and lead time from the factory.

Sample: **FR1315** **H** **S** **12** **K** **4P** **X** **X** **FS6** **FF** **PM**
Finished Order: **FR1315HS12K4PXXFS6FFPM**

1 Basic Series

FR1303 = 1 - 30 psig
FR1306 = 5 - 60 psig
FR1310 = 10 - 100 psig
FR1315 = 15 - 150 psig

2 Source Pressure Range

H = 0 - 600 psig

3 Body Material

S = 316L SS*

4 Flow Capacity

12 = 1.2 Cv

5 Seat Material

K = PCTFE
V = Polyimide

6 Porting*

2P = 2 Ports
3P = 3 Ports
4P = 4 Ports

* Refer to the Regulator Porting Guide, 25000156, for additional porting

7 Outlet Gauge*

X = No Gauge
03 = 0 - 30 psig
0L = 0 - 60 psig
01 = 0 - 100 psig
2 = 0 - 200 psig
4 = 0 - 400 psig

* Only include with "3P" or "4P" body configurations.

8 Inlet Gauge*

X = No Gauge
01 = 0 - 100 psig
4 = 0 - 400 psig
10 = 0 - 1000 psig
20 = 0 - 2000 psig

* Only include with "4P" body configuration.

9 Port Style

FS = 1/4" Face Seal
FS6 = 3/8" Face Seal *
TS6 = 3/8" Tube Stub
FS8 = 1/2" Face Seal
TS8 = 1/2" Tube Stub
FS12 = 3/4" Face Seal
TS12 = 3/4" Tube Stub

* Provided with 1/2" face seal nuts.

10 Port Configuration

M = Male
F = Female
I = Internal Face Seal
(gauge ports only)

* 1/4" FS-M Gauge Ports are Standard
Any other gauge port configuration may have an extended lead time.

11 Optional Features

This section can have multiple options

Blank = None
PM = Panel Mount

FR1300 Series

Specifications

Wetted Materials of Construction	
Body	316L SS
Diaphragm	Ni-Cr-Mo alloy (Hastelloy® or equivalent)
Poppet	316L SS
Poppet Spring	316L SS
Seat Retainer	316L SS
Seat	PCTFE (std), Polyimide
Finish	Passivated & Electropolished

For additional information on materials of construction, functional performance and operating conditions, please refer to Veriflo report RI.EN.RP021.

All specifications subject to change without notice.

Hastelloy® is a registered trademark of Haynes International, Inc.

Functional Performance	
<i>Flow Capacity (Cv)</i>	1.2
Internal Leakage (seat)	Bubble Tight
External Leakage (Inboard)	$\leq 2 \times 10^{-10}$ scc/sec He
<i>Supply Pressure Effect</i>	5.9 psig / 100 psig
<i>Internal Volume</i>	
1/4" Face Seal	1.02 in ³ (16.7 cm ³) ¹
1/2" Face Seal	1.41 in ³ (23.1 cm ³) ¹
3/4" Face Seal	2.42 in ³ (39.7 cm ³) ¹
<i>Proof Pressure</i>	900 psig
<i>Burst Pressure</i>	1,800 psig
<i>Approx. Weight</i>	4.3 lbs (2.0 kg)
Operating Conditions	
Maximum Inlet Pressure	600 psig ²
Temperature	-40°F to 150°F (-40°C to 65°C)
Mounting	Surface (std)
	Panel (1.50 in. [38.1 mm] hole required)

1. Internal volume includes end connections.
2. Pressure rating based on nominal temperature conditions. Refer to Veriflo report RI.EN.RP021 for specific information regarding regulator performance at temperature.

OFFER OF SALE:

The items described in this document are hereby offered for sale by Parker-Hannifin Corporation, its subsidiaries or its authorized distributors. This offer and its acceptance are governed by the provisions stated in the detailed "Offer of Sale" elsewhere in this document or available at www.parker.com/veriflo



WARNING USER RESPONSIBILITY

FAILURE OR IMPROPER SELECTION OR IMPROPER USE OF THE PRODUCTS DESCRIBED HEREIN OR RELATED ITEMS CAN CAUSE DEATH, PERSONAL INJURY AND PROPERTY DAMAGE. THIS DOCUMENT IS FOR REFERENCE ONLY. PLEASE CONSULT FACTORY FOR LATEST PRODUCT DRAWINGS AND SPECIFICATIONS

This document and other information from Parker-Hannifin Corporation, its subsidiaries and authorized distributors provide product or system options for further investigation by users having technical expertise.

The user, through its own analysis and testing, is solely responsible for making the final selection of the system and components and assuring that all performance, endurance, maintenance, safety and warning requirements of the application are met. The user must analyze all aspects of the application, follow applicable industry standards, and follow the information concerning the product in the current product catalog and in any other materials provided from Parker or its subsidiaries or authorized distributors.

To the extent that Parker or its subsidiaries or authorized distributors provide component or system options based upon data or specifications provided by the user, the user is responsible for determining that such data and specifications are suitable and sufficient for all applications and reasonably foreseeable uses of the components or systems.

The products described herein, including without limitation, product features, specifications, designs, availability and pricing are subject to change by Parker Hannifin Corp and its subsidiaries at any time without notice.

Proposition 65 Warning: This product contains chemicals known to the state of California to cause cancer or birth defects or other reproductive harm.