

SM930 Series

UHP Surface Mount Diaphragm Valve
1-1/8" & 1-1/2", Stainless Steel

aerospace
climate control
electromechanical
filtration
fluid & gas handling
hydraulics
pneumatics
process control
sealing & shielding

Value Proposition:

Parker Hannifin Corporation's Veriflo Division presents the Surface Mount 930 Air Operated and Manual Diaphragm Valve. The SM930 diaphragm valve provides exceptional performance for today's modular surface mount systems.



Contact Information:

Parker Hannifin Corporation
Veriflo Division
250 Canal Blvd
Richmond, California 94804

phone 510 235 9590
fax 510 232 7396
veriflo.sales@parker.com

www.parker.com/veriflo
Mobile App: m.parker.com/veriflo

Product Features:

- “VeriClean”, Veriflo’s custom low sulfur high purity 316L Stainless Steel™ enhances electropolishing, welding and corrosion resistance
- Fully field serviceable seat (special tool required)
- Internally threadless and springless
- Standard full internal electropolish
- Fully functional for pressure ranges from vacuum to 125 psig for Air Operated and Toggle (G) valves and 250 psig for manual (I, K, M) valves
- Change from air operated actuator to lever or visa versa without intruding into wetted area
- 100% Helium leak tested



ENGINEERING YOUR SUCCESS.

SM930 Series

Dimensional Drawings

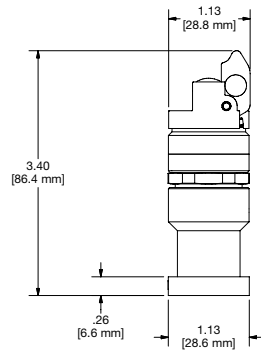

SM930 K

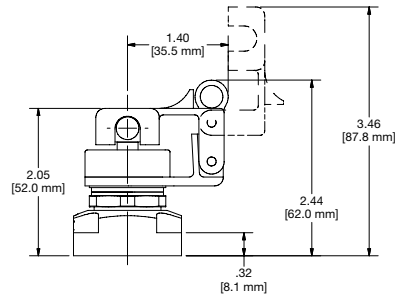

SM930 M LK

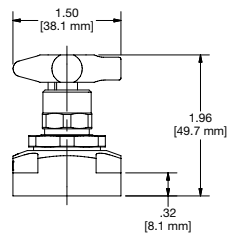

SM930 M

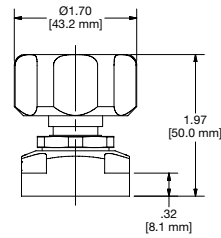

SM930 I

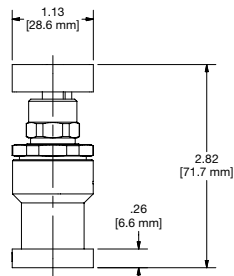

SM930 M 2

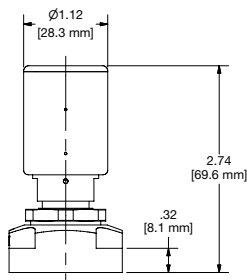

SM930 LPNC

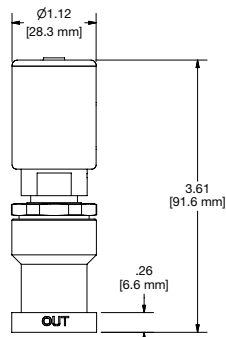

SM930 LP1NC2

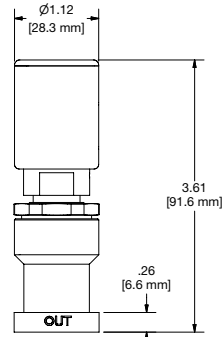

SM930 LPNC2

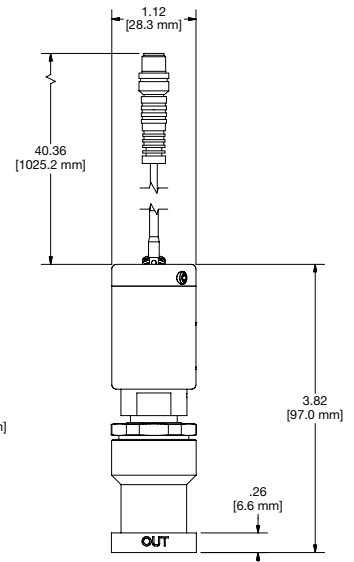

SM930 LP1NCPS

SM930 Series

Ordering Information

Build an SM930 Series valve by replacing the numbered symbols with an option from the corresponding tables below.





Contact factory for most up to date lead time information.

Blue = Configurations that have selections in blue may have an extended lead time and a minimum order quantity.

Sample: **SM930** **M** **S** **10** **VESP**
 Finished Order: **SM930MS10VESP**

- 1 Type**
- G = Toggle
 - I = **Indicating Handwheel**
 - K = LockOut-TagOut Manual Valve
 - M = Mini-Lever
 - LPNC = Air Operated Normally Closed**
 - LPNO = Air Operated Normally Open**
 - LP1NC = Air Operated Normally Closed with 1/8" O.D. Integral Cartridge Fitting
- Consult Factory for additional Handle Colors*

- 2 Body Material**
- S = 316L Stainless Steel

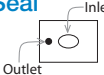
- 3 Porting**
- 10 =  = 2 Port, Standard C-Seal
 - 20 =  = 3 Port, Standard C-Seal
 - 30 =  = 3 Port, Standard C-Seal
 - 60 =  = "W" Seal
- 

- 4 Base Size**
- = 1-1/2" Interface
 - 2 = 1-1/8" Interface

- 5 Optional Features**
 This section can have multiple options
- LK = **LockOut-TagOut LOTO Clamp for M type Valve**
 - LSC = Limit Switch Closed**
Available with LPNC Options Only
 - LSO = **Limit Switch Open**
Available with LPNC Options Only
 - VESP = **VespeI® Seat**
Recommended for Nitrous Oxide (N2O) Service
 - PEEK = PEEK™ Seat**
 - NPNO = NPN Proximity Switch, 8" Long Cable**
Available with Normally Open or Normally Closed Actuators
 - NPNO1 = NPN Proximity Switch, 40" Long Cable**
Available with Normally Open or Normally Closed Actuators

NPN CONNECTOR PIN CONFIGURATION:

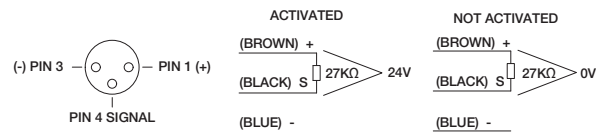

SM930 Series

Specifications

Materials of Construction	
Wetted	
Body	VeriClean™ 316L Stainless Steel
Diaphragm	Elgiloy® or equivalent
Seat Options	PCTFE (std), PEEK™ or Vespel®
Non-wetted	
Cap	17-4 Stainless Steel
Nut	316L Stainless Steel
Operating Conditions	
Maximum Pressure	
LPNC, LPNO, LP1NC, G	125 psig (8.6 barg)
I, K, M	250 psig (17.2 barg)
Minimum Pressure	
Vacuum	
AOP Actuation Pressure	
75 psig (5.2 barg) nominal	
Temperature	
-40°F to 150°F (-40°C to 66°C)	
Bake Out	
250°F (121°C) in the open position	

For additional information on materials of construction, functional performance and operating conditions, please contact factory.

Vespel® is a registered trademark of DuPont Performance Elastomers L.L.C.
 Elgiloy® is a registered trademark of Elgiloy Company
 VeriClean™ is a trademark of Parker Hannifin Corporation
 PEEK™ is a trademark of Victrex plc.

Functional Performance	
Design	
Burst Pressure	
LPNC, LPNO, LP1NC, G	375 psig (25.9 barg)
I, K, M	750 psig (51.7 barg)
Proof Pressure	
LPNC, LPNO, LP1NC, G	188 psig (13.0 barg)
I, K, M	375 psig (25.9 barg)
Design Pressure ⁽¹⁾	
LPNC, LPNO, LP1NC, G	151 psig (10.4 barg)
I, K, M	276 psig (19.0 barg)
Flow Capacity	
LP	C _v 0.25
1/4 Turn Manual	C _v 0.20
Leak Rate	
Inboard Test Method	
Internal	< 1 x 10 ⁻⁹ scc/sec He
External	< 2 x 10 ⁻¹⁰ scc/sec He
Surface Finish	
5 micro inch Ra or less	

1. Design pressure per KOSHA Guide D-5-2012, Para. 6.2

OFFER OF SALE:

The items described in this document are hereby offered for sale by Parker-Hannifin Corporation, its subsidiaries or its authorized distributors. This offer and its acceptance are governed by the provisions stated in the detailed "Offer of Sale" elsewhere in this document or available at www.parker.com/veriflo



FAILURE OR IMPROPER SELECTION OR IMPROPER USE OF THE PRODUCTS DESCRIBED HEREIN OR RELATED ITEMS CAN CAUSE DEATH, PERSONAL INJURY AND PROPERTY DAMAGE. THIS DOCUMENT IS FOR REFERENCE ONLY. PLEASE CONSULT FACTORY FOR LATEST PRODUCT DRAWINGS AND SPECIFICATIONS

This document and other information from Parker-Hannifin Corporation, its subsidiaries and authorized distributors provide product or system options for further investigation by users having technical expertise.

The user, through its own analysis and testing, is solely responsible for making the final selection of the system and components and assuring that all performance, endurance, maintenance, safety and warning requirements of the application are met. The user must analyze all aspects of the application, follow applicable industry standards, and follow the information concerning the product in the current product catalog and in any other materials provided from Parker or its subsidiaries or authorized distributors.

To the extent that Parker or its subsidiaries or authorized distributors provide component or system options based upon data or specifications provided by the user, the user is responsible for determining that such data and specifications are suitable and sufficient for all applications and reasonably foreseeable uses of the components or systems.

The products described herein, including without limitation, product features, specifications, designs, availability and pricing are subject to change by Parker Hannifin Corp and its subsidiaries at any time without notice.

Proposition 65 Warning: This product contains chemicals known to the state of California to cause cancer or birth defects or other reproductive harm.

© 2009 Parker Hannifin Corporation



Use mobile device to scan this QR Code.

LitPN: 25000146

Rev: H

Date of Issue 04/2019



ENGINEERING YOUR SUCCESS.