

# DFC

## Portable Diesel Fuel Filtration Cart

Practical and economical maintenance tool.

Parker’s comprehensive asset health management approach extends well beyond traditional methods and brings focus to long term fuel system performance and reliability. Pre-filtration and transfer of diesel and biodiesel fuels is critical in maintaining today’s fuel injection systems and extending system component life.

Tight tolerances and higher system pressures require significant improvement in fuel cleanliness and quality. The Parker Diesel Fuel Cart delivers on the promise of high efficiency removal of harmful contaminants that impact injector life and compromise engine performance. Like most fuels, diesel requires filtration prior to use and after long periods of storage.

The use of the Parker Diesel Fuel Cart is a practical and economical maintenance tool that contributes to optimum engine performance, regardless of application.



**Designed for Diesel and Biodiesel blended fuels only. Do not use with Gasoline.**

Features	Advantages	Benefits
Wide variety of elements available	Meets cleanliness standards	Extends component life and improves system performance
Heavy duty frame	Rugged and durable	Built to last
Lightweight and portable	Easy to move from place-to-place	One operator
Eleven-foot hose and wand assemblies included	Additional hardware not necessary	Ready to use as received
Parker’s E-Z FORM™ MP Series 7219 kink-resistant nitrile hose	Low pressure suction/return hose and vehicle fuel fill connector line	Specifically made for diesel
Visual indicator		Tells you when to change element
FBO-14 fuel filter	Does not require any tools for filter change outs	Polishes fuel
110V/220V AC motor		
Parker H series gear pump	Fixed displacement loaded gear pump which has a high tolerance to system contamination	Long life
Drip tray		Helps keep the work area safe and clean
Convenient inlet-to-outlet hose connection.	Contains fluids when transporting	Clean and safe operation
Low center of gravity.	Guardian stability	Unattended reliability
Dual motor seals.	Added motor protection	Longer motor life
Auxiliary inlet/outlet ports.	Used in place of, or in addition to, standard ports. The outlet can also be used as a sampling port.	Flexibility

# DFC

## Specifications

<b>Maximum Recommended Fluid Viscosity</b>	Diesel – 200 SUS (44 cSt); 0.85 specific gravity
<b>Flow Rate</b>	16 gpm (60.5 lpm)
<b>Visual Indicator</b>	15 psid (1.03 bar) visual differential
<b>Operating Temperature</b>	17.5°F to +150°F (-8.1°C to +66°C)
<b>Electrical Service Required</b>	110/220 volts, 60/50 Hz, single phase, 9.6/4.8 amp
<b>Electrical Motor</b>	¾ hp @ 3450 rpm, TEFC
<b>Recommended Fluids</b>	Diesel fuels
<b>Construction</b>	Cart frame – Steel Filter head – Die Cast Filter bowl – Steel Hoses – Nitrile Wands – PVC
<b>Weight</b>	107 lbs. (48.5 kg)
<b>Dimensions</b>	Height: 40.7 in (1034 mm) Width: 25.5 in (648 mm) Depth: 19.8 in (503 mm)

### Element Performance

New Tier 4 Diesel Engines require finer filtration and better performance

Typical engine fuel contamination levels, established in 1998 by Worldwide Fuel Charter Committee, required cleanliness of 18/16/13 per ISO 4406. Due to technology advances in High Pressure Common Rail injection systems, the new engines manufactured today require cleanliness levels as low as **12/9/6 or better**. Injector pressures are exceeding 30,000 psi (2,068 bar) and smaller nozzle openings are driving the requirements.

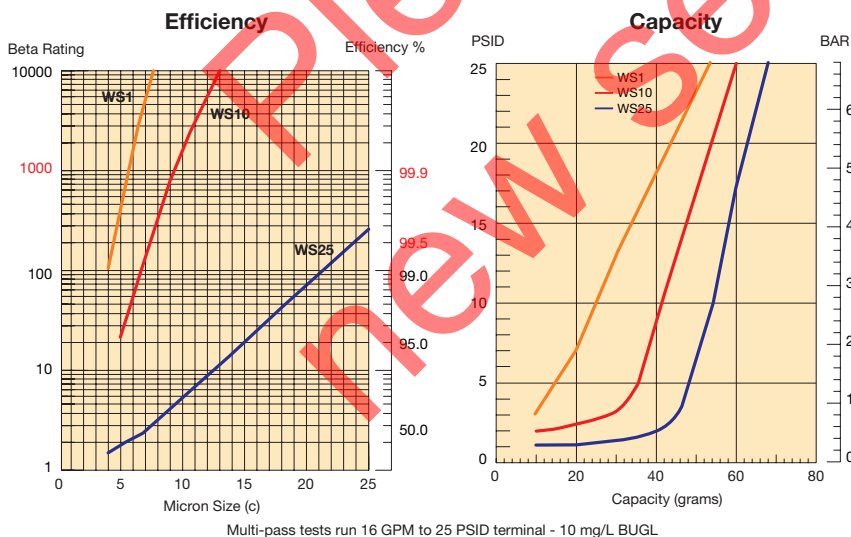

### Element Choices

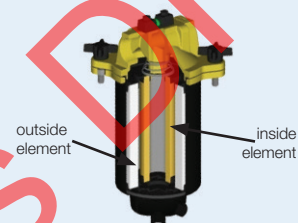

**WS** - Water separator elements are critical when there is a need to remove both particulate and water contamination from fuels. Testing has shown the WS 25 micron element is capable of achieving >99.5% single pass particulate removal efficiency.

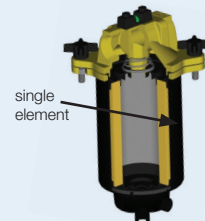

**ST** - Silicone treated elements are ideal for removing particulate contaminants like dust, dirt, rust, sand, scale etc. from fuels. Testing has shown the ST 25 micron elements are capable of achieving >98.8% single pass particulate removal efficiency.

# DFC

## Replacement Parts

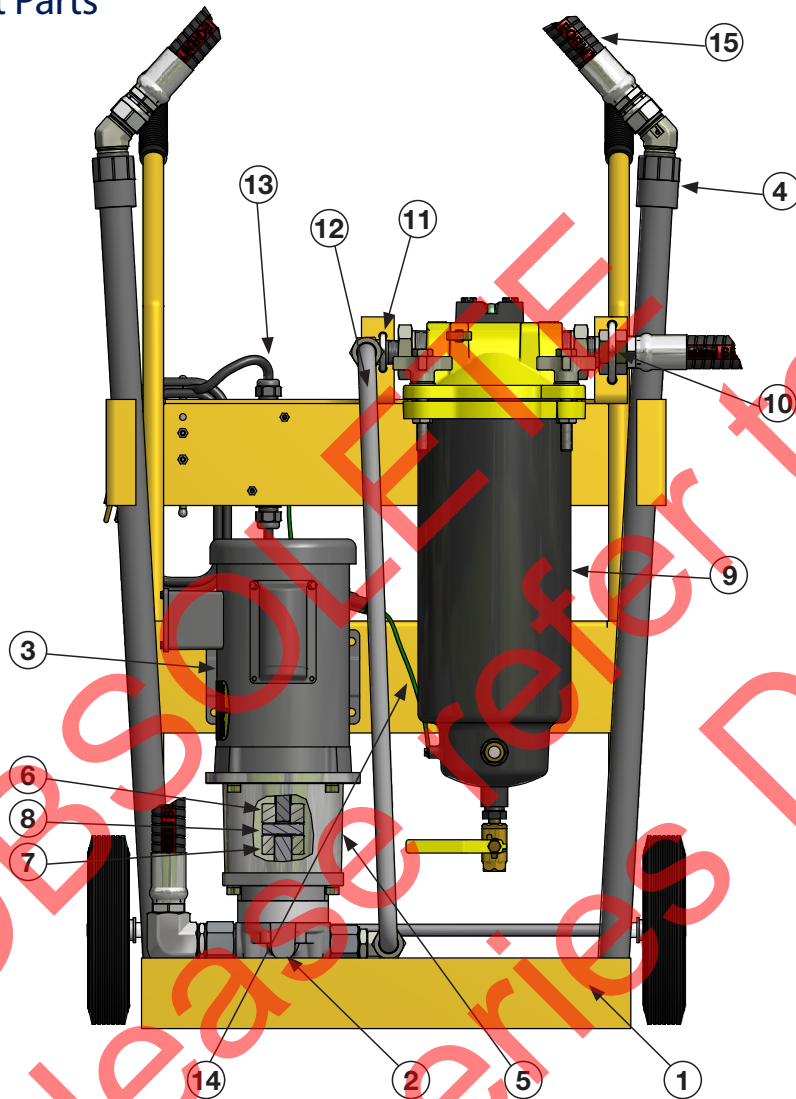

### Parts List

#	Part Number	Description	Qty.	#	Part Number	Description	Qty.
1	945602	DFC cart frame assembly	1	9	945513	Filter housing FBO-14	1
2	943389	H49 gear pump H49AAIAV	1	10	945512	U Bolt SS 5/16-18 thread 2-11/16"	1
3	945579	3/4 HP motor 3600 RPM 60 hz C-face	1	11	945511	U Bolt SS 1/4-20 thread 2" long	1
4	928784	PVC wand - 3 ft	2	12	945508	Tube assembly 3/4 OD 25.11" long	1
5	943042	Pump adapter	1		928616	Heater element (not shown)	1
6	943087	Coupling Lovejoy L075.625	1	13	928617	Manual motor starter (on back)	1
7	943088	Coupling Lovejoy L075.750	1	14	CF	Deutsch connector assembly ground wire	1
8	943133	Spider nitrile L075	1	15	945582B	Hose assembly E-Z Form series 7219 - 8 ft	2

CF - Consult Factory

# DFC

## Portable Diesel Fuel Filtration Cart

### How to Order

Select the desired symbol (in the correct position) to construct a model code. Example:

BOX 1	BOX 2	BOX 3	BOX 4	BOX 5	BOX 6	BOX 7	BOX 8
DFC	14	WS	10	V	V	X	1

BOX 1: Filter Series	
Symbol	Description
DFC	Standard Cart

BOX 2: Model Length	
Symbol	Description
14	Double

BOX 3: Media Code	
Symbol	Description
WS	Water Separator
ST	Silicone Treated Particulate

BOX 4: Degree of Filtration	
Symbol	Description
01	1 micron
10	10 micron
25	25 micron

BOX 5: Seals	
Symbol	Description
V*	Fluorocarbon (FKM)

\* E-Z Form™ MP 7219 Nitrile Hose

BOX 6: Indicator	
Symbol	Description
V	Differential Visual

BOX 7: Bypass	
Symbol	Description
X	No Bypass

BOX 8: Options	
Symbol	Description
1	None

### Replacement Elements

Element	Micron Rating	Coalescer/ Separator	Particulate
FBO-14	1	945515	945519
	10	945517	945521
	25	945518	945522

### Accessories

Part Number	Description
945292	Concentric Wand

Single Point Suction & Return

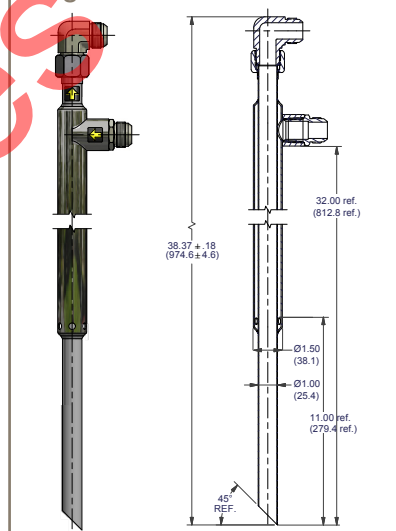

945292

- 1" diameter suction tube
- Fits in openings 1.5 inches and larger
- 32" suction depth
- In-tank filtering
- One port access to the tank
- All steel construction